

STEP 5

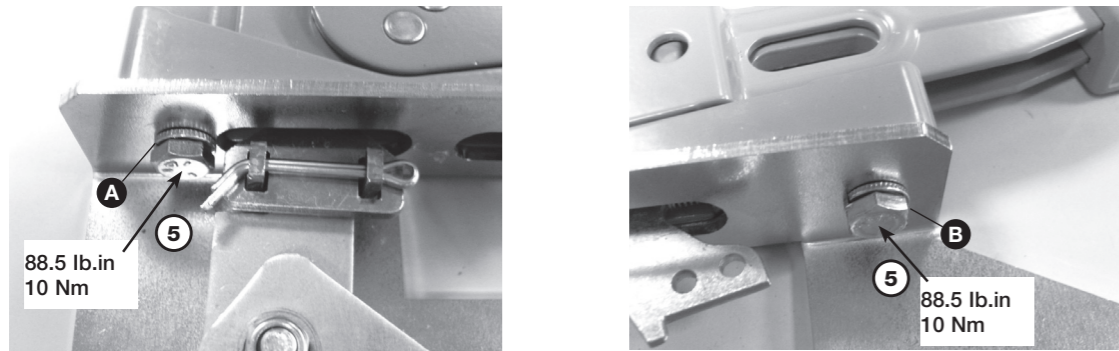

STEP 6

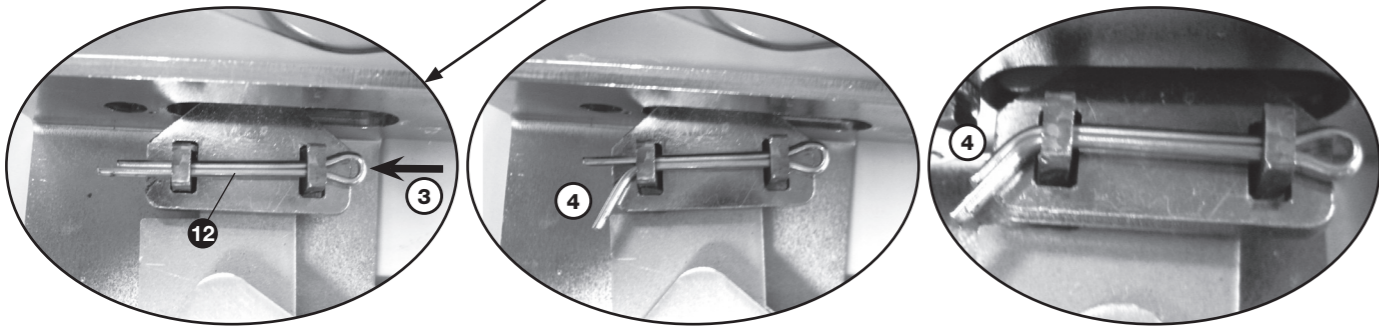
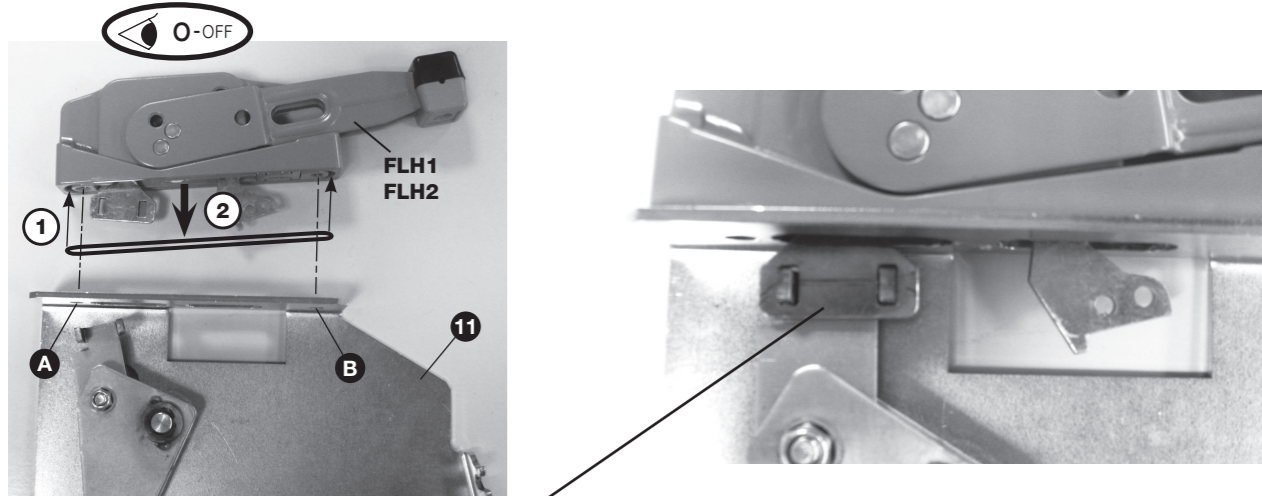
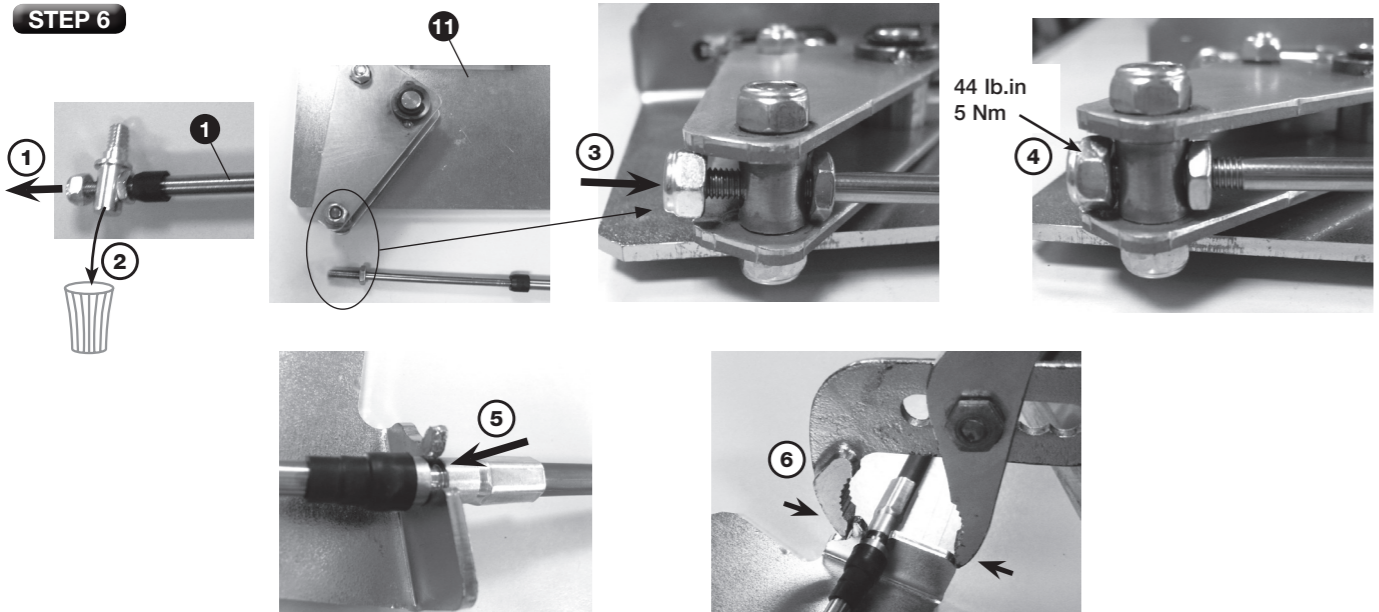

COOPER

Bussmann™

CABLE FLANGE FOR UL98 FUSIBLE DISCONNECT SWITCHES

⚠ DANGER / DANGER / PELIGRO

HAZARDOUS VOLTAGE

- This equipment must be installed and serviced only by qualified electrical personnel.
- Turn off all power supplying this equipment before working on or inside equipment.
- Always use a properly rated voltage sensing device to confirm power is OFF.
- Replace all devices, doors, and covers before turning on power to this equipment.
- Maintain electrical clearances between cable and live parts.

Failure to follow these instructions will result in death or serious injury.

TENSION DANGEREUSE

- L'installation et l'entretien de cet appareil ne doivent être effectués que par du personnel qualifié.
- Coupez l'alimentation de cet appareil avant d'y travailler.
- Utilisez toujours un dispositif de détection de tension à valeur nominale approprié pour confirmer que toute alimentation est coupée.
- Remplacez tous les dispositifs, les portes et les couvercles avant de mettre cet appareil sous tension.
- Maintenez les distances d'isolement électrique entre le câble et les pièces sous tension.

Si ces précautions ne sont pas respectées, cela entraînera la mort ou des blessures graves.

TENSION PELIGROSA

- Solamente el personal de mantenimiento eléctrico especializado deberá instalar y prestar servicios de mantenimiento a este equipo.
- Desenergice el equipo antes de realizar cualquier trabajo en él.
- Siempre utilice un dispositivo detector de tensión adecuado para confirmar la desenergización del equipo.
- Vuelva a colocar todos los dispositivos, las puertas y las cubiertas antes de energizar este equipo.
- Mantenga un espacio adecuado para la instalación eléctrica entre el cable y las piezas energizadas.

El incumplimiento de estas precauciones podrá causar la muerte o lesiones serias.

USED WITH
UTILISEES AVEC
UTILIZACIÓN CON

| | | | | | |
|---|----------|---------------|----------|-----------|-----------|
| } | RDF30J-2 | RDF60J-2-COMP | RDF60J-2 | RDF100J-2 | RDF200J-2 |
| | RDF30J-3 | RDF60J-3-COMP | RDF60J-3 | RDF100J-3 | RDF200J-3 |
| | RDF30J-4 | RDF60J-4-COMP | RDF60J-4 | RDF100J-4 | RDF200J-4 |

Dual dimensions in/mm
Double dimensions in/mm
Doble dimensiones in/mm

FLC36
FLC60
FLC120

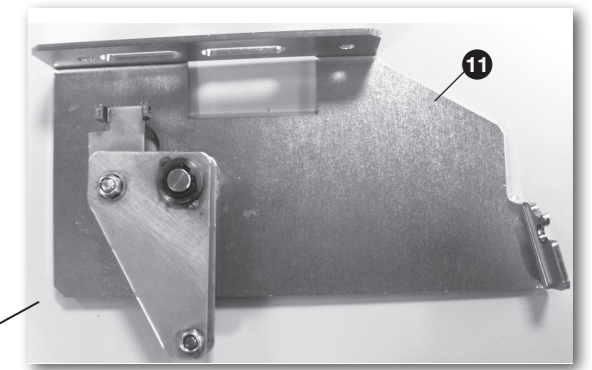

FLCM

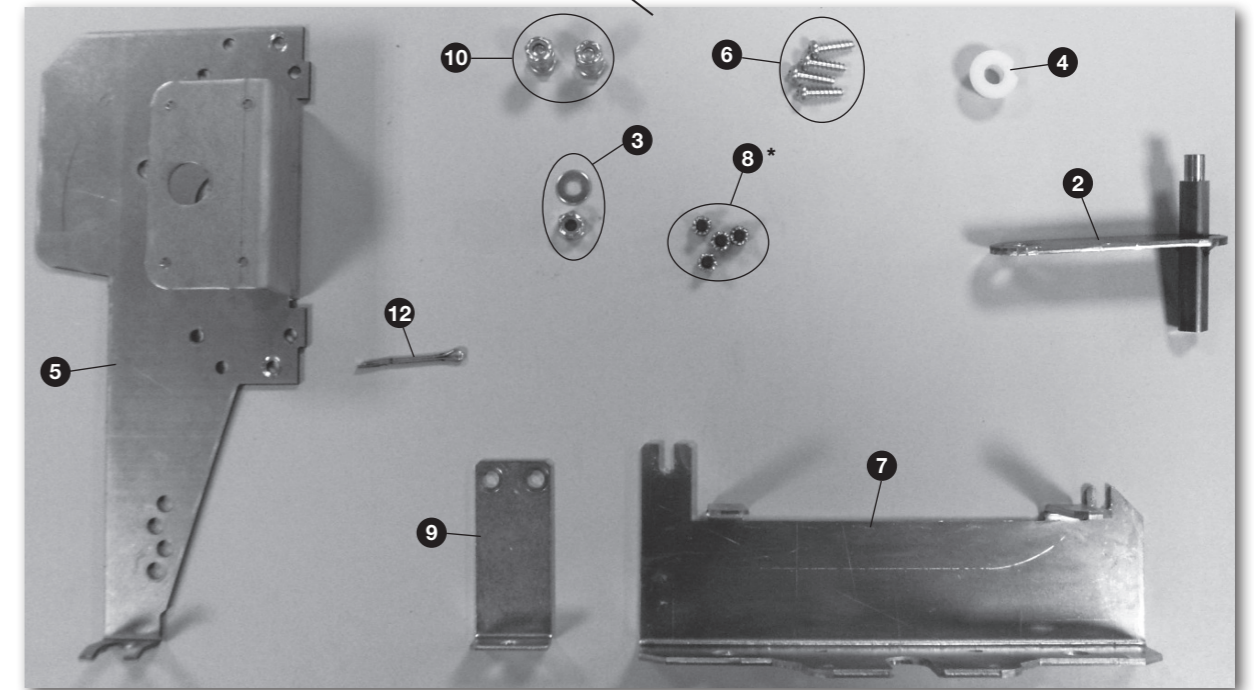

STEP 1

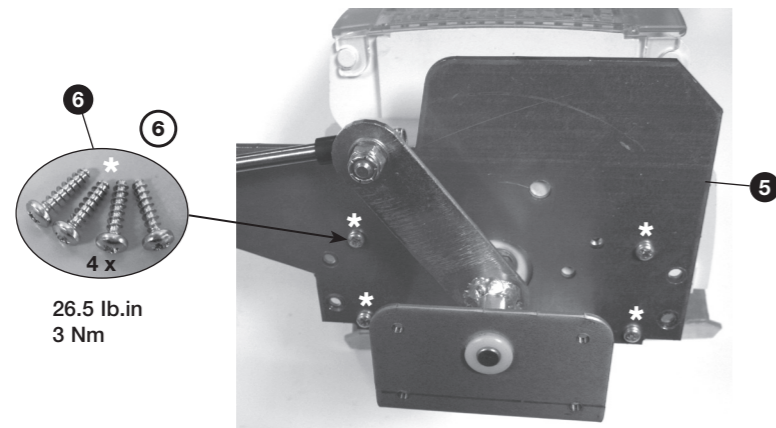
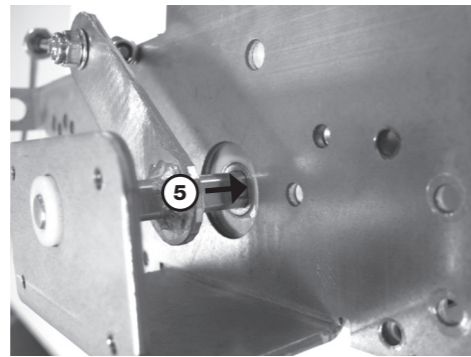
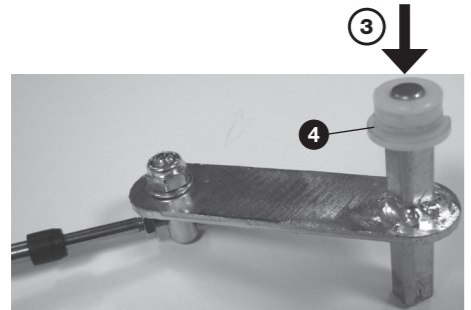
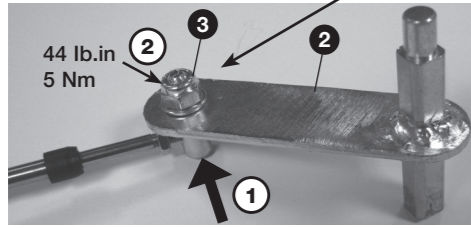
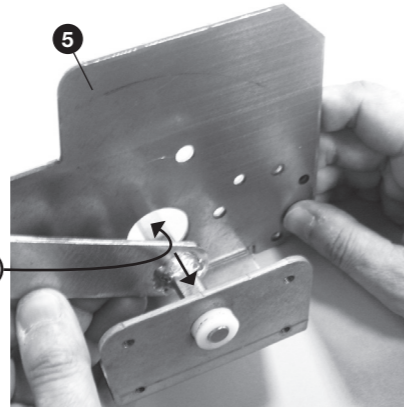
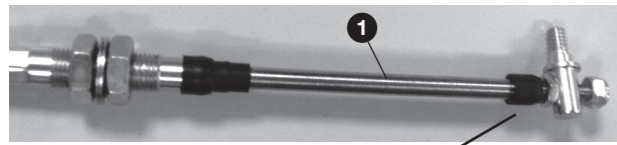

STEP 2

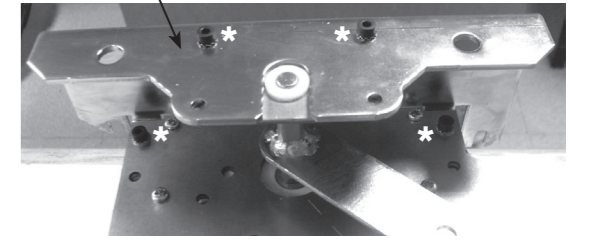
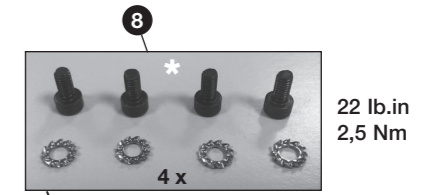
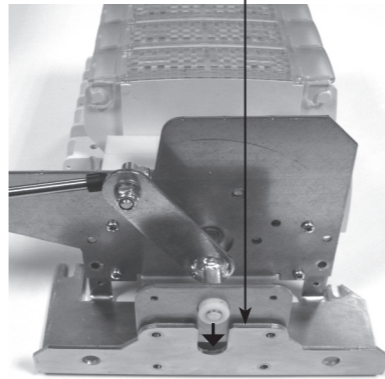
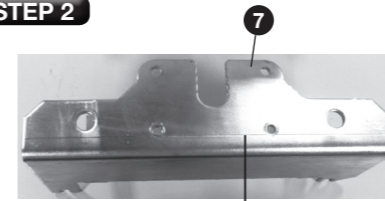

STEP 3

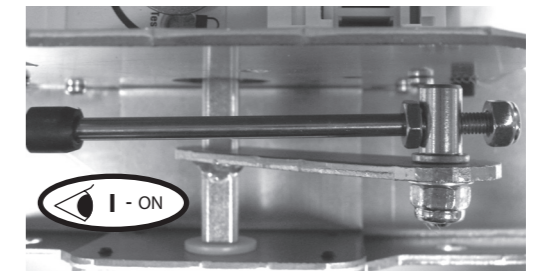
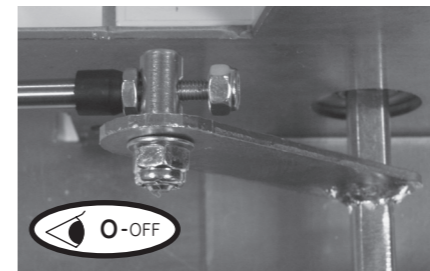
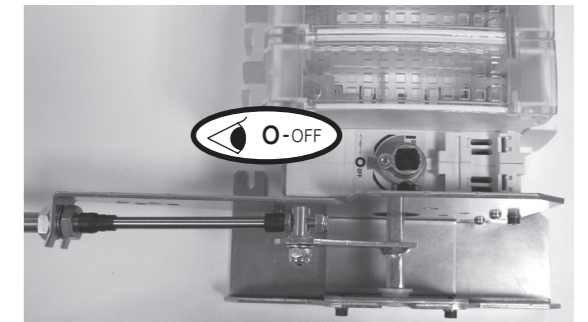
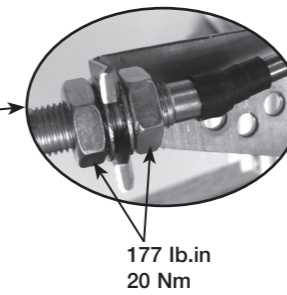
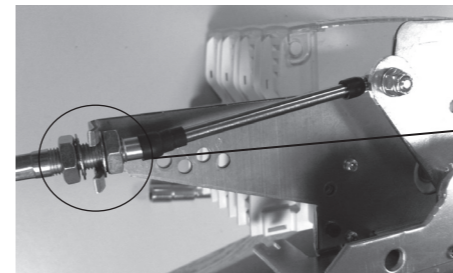

STEP 4

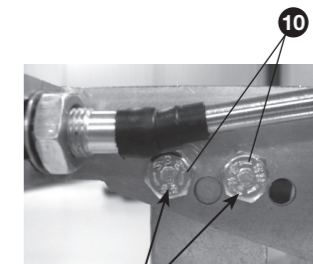
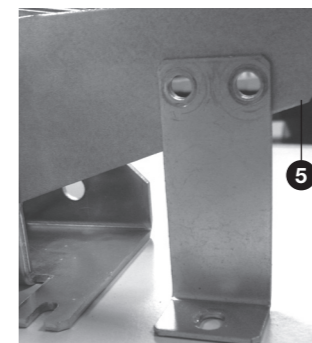
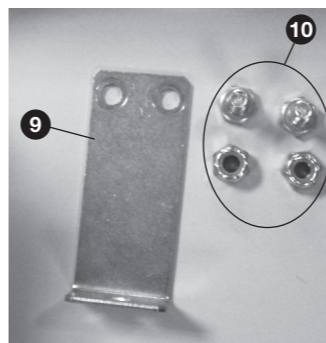

44 lb.in
5 Nm