

Tous droits strictement reserves. Reproduction ou communication a des tiers interdite sous quelque forme que ce soit sans autorisation écrite du propriétaire. Propriete de c FCI. Droits de reproduction FCI.

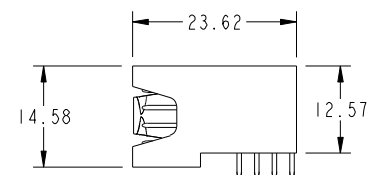

All rights strictly reserved. Reproduction or issue to third parties in any form whatever is not permitted without written authority from the proprietor. Property of FCI. Copyright FCI.

PRODUCT NO.	ROWS	POWER				S		
		P1	P2	P3	P4	1	2	3
51736-007-- NOTE 3	D C B A	PA	PA	PA	PA	UUU TTT SSS RRR		

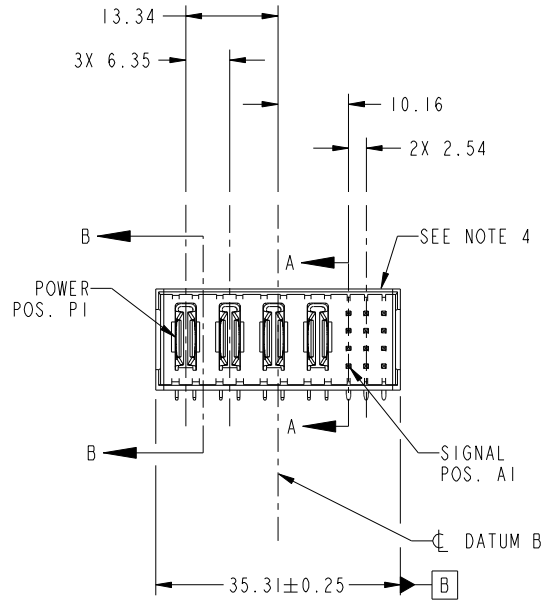

CODE	DIM "M" MATING LENGTH	CONTACT TYPE
U	[6.86]	SIGNAL
T	[6.86]	SIGNAL
S	[6.86]	SIGNAL
R	[6.86]	SIGNAL
PA	[N/A]	POWER
E	[5.59]	SIGNAL

mat'l code				SEE NOTE		tolerances unless otherwise specified		CUSTOMER		FCI	
ltr	ecn no.	dr	date	linear		0.X ±0.5	COPY		www.fciconnect.com		
A	DG10-0268	AL	07/19/10			0.XX ±0.25	projection		title		
				angles		0.XXX ±0.1			4P + 12S RIGHT ANGLE SOLDER HEADER		
				dr	Anson Liu	07/19/10			product family		PwrBlade
				enrg	Jerome Chen	07/19/10			size		code
				chr	PM ZHENG	07/19/10	scale		dwg no		213
				appd	JOSEPH HSIA	07/19/10	1:1		A		51736-007
sheet index		revision sheet		A	A	A	A			sheet	
				1	2	3	4			1 of 4	

cage code 22526

Tous droits strictement reserves. Reproduction ou communication a des tiers interdite sous quelque forme que ce soit sans autorisation écrite du propriétaire. Propriete de c FCI. Droits de reproduction FCI.

All rights strictly reserved. Reproduction or issue to third parties in any form whatever is not permitted without written authority from the proprietor. Property of FCI. Copyright FCI.



PRODUCT NUMBER  
51736-007\_  
NOTE: 3

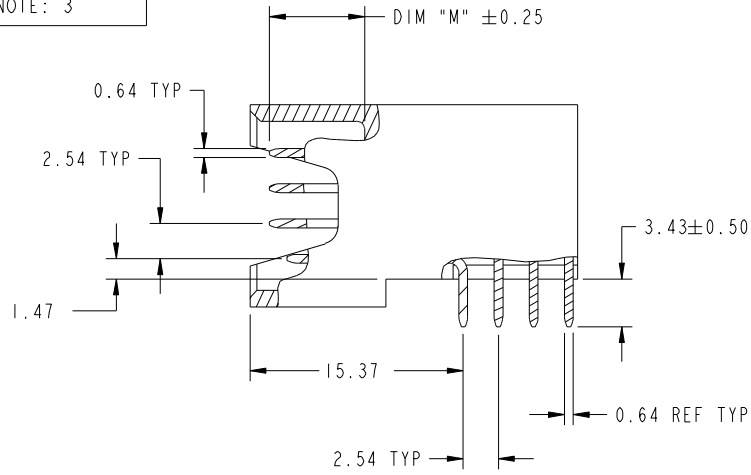

BROKEN-OUT SECTION A-A  
SCALE 2:1

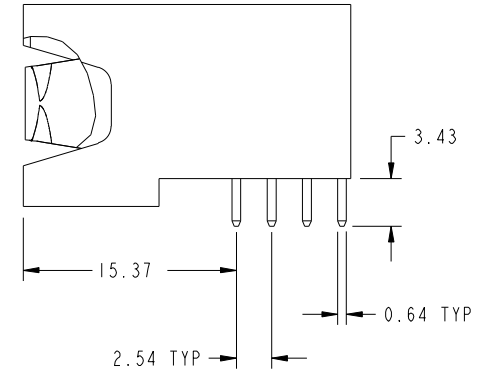

BROKEN-OUT SECTION B-B  
SCALE 2:1

mat'l code		SEE NOTE		tolerances unless otherwise specified		CUSTOMER		FCI	
ltr	ecn no.	dr	date	linear	0.X ±0.5	COPY		www.fciconnect.com	
A					0.XX ±0.25	projection		title	
				angles	0.XXX ±0.1			4P + 12S RIGHT ANGLE SOLDER HEADER	
				dr	0° ±2°	MIM		product family PwrBlade code	
				enr	Anson Liu 07/19/10			size	
				chr	Jerome Chen 07/19/10	scale		dwg no	
				appd	PM ZHENG 07/19/10	1:1		A 51736-007	
					JOSEPH HSIA 07/19/10			sheet	
sheet index	revision sheet							2 of 4	

cage code 22526

Pro/E

Tous droits strictement reserves. Reproduction ou communication a des tiers interdite sous quelque forme que ce soit sans autorisation écrite du propriétaire. Propriete de c FCI. Droits de reproduction FCI.



All rights strictly reserved. Reproduction or issue to third parties in any form whatever is not permitted without written authority from the proprietor. Property of FCI. Copyright FCI.

PRODUCT NUMBER  
51736-007\_  
NOTE: 3

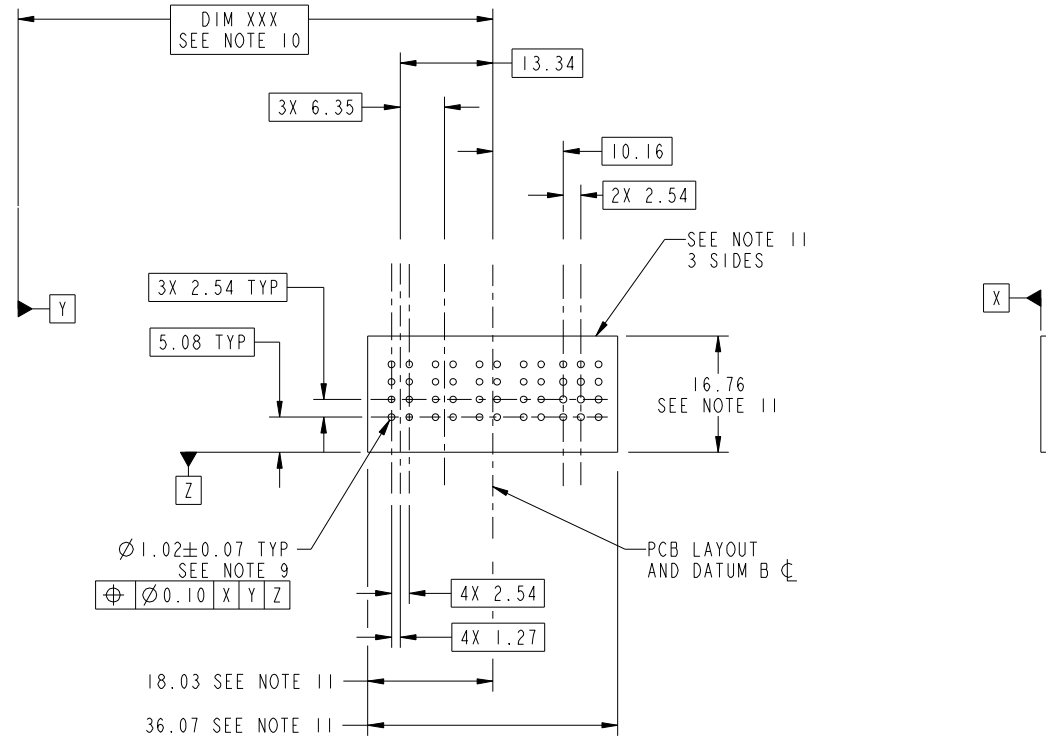

RECOMMENDED PCB LAYOUT

mat'l code		SEE NOTE		tolerances unless otherwise specified		CUSTOMER		FCI	
ltr	ecn no.	dr	date	linear	$0.X \pm 0.5$	COPY		www.fciconnect.com	
A					$0.XX \pm 0.25$	projection	title 4P + 12S RIGHT ANGLE SOLDER HEADER		
				angles	$0.XXX \pm 0.1$				
					$0^\circ \pm 2^\circ$	MIM	product family	PwrBlade	code
				dr	Anson Liu 07/19/10	scale	size	dwg no	213
				enr	Jerome Chen 07/19/10	1:1	A	51736-007	sheet
				chr	PM ZHENG 07/19/10				3 of 4
				appd	JOSEPH HSIA 07/19/10				
sheet index	revision sheet								

cage code 22526

Pro/E

Tous droits strictement reserves. Reproduction ou communication a des tiers interdite sous quelque forme que ce soit sans autorisation écrite du propriétaire. Propriete de c FCI. Droits de reproduction FCI.



All rights strictly reserved. Reproduction or issue to third parties in any form whatever is not permitted without written authority from the proprietor. Property of FCI. Copyright FCI.

PRODUCT NUMBER  
51736-007\_  
NOTE: 3

NOTES:

1. DIMENSIONS AND TOLERANCES ARE IN ACCORDANCE WITH ASME Y14.5M, 1994 UNLESS OTHERWISE SPECIFIED.

CONNECTOR NOTES:

- 2. HOUSING MATERIAL: UL 94 V-0 GLASS FILLED HIGH-TEMP THERMOPLASTIC  
POWER CONTACT MATERIAL: COPPER ALLOY  
SIGNAL PIN MATERIAL: COPPER ALLOY
- 3. SEE ITEM 1 & 2 IN PRINT 10064183 FOR PLATING SPEC OF 51736-007 AND 51736-007LF RESPECTIVELY.
- 4. MANUFACTURER'S NAME, DATE CODE AND OPTIONAL P/N TO APPEAR ON THIS SURFACE. THE P/N CAN BE OMITTED IF THERE IS NOT ENOUGH SPACE ON THIS SURFACE.
- 5. PRODUCT SPECIFICATION GS-12-149.  
APPLICATION SPECIFICATION BUS-20-067.
- 6. PACKAGED IN TRAYS.

PCB NOTES:

- 7. ALL HOLE DIAMETERS ARE FINISHED HOLE SIZE.
- 8. MOUNTING HOLES, WHERE APPLICABLE, ARE UNPLATED.
- 9.  $\varnothing 1.151 \pm 0.025$  DRILLED HOLES PLATED WITH  
0.008 MIN SnPb OR Sn OVER 0.03  
TO 0.08 Cu PLATING TO ACHIEVE  
 $\varnothing 1.02 \pm 0.07$  HOLE.
- 10. "DIM XXX" TO BE DETERMINED BY THE CUSTOMER.
- 11. CONNECTOR KEEP-OUT ZONE.

mat'l code		SEE NOTE		tolerances unless otherwise specified		CUSTOMER		FCI	
ltr	ecn no.	dr	date	linear	0.X ± 0.5	COPY		www.fciconnect.com	
A				linear	0.XX ± 0.25	projection		title 4P + 12S RIGHT ANGLE SOLDER HEADER	
				angles	0.XXX ± 0.1			product family	PwrBlade
				dr	Anson Liu 07/19/10	scale	size	dwg no	213
				enrg	Jerome Chen 07/19/10	1:1	A	51736-007	sheet
				chr	PM ZHENG 07/19/10				4 of 4
				appd	JOSEPH HSIA 07/19/10				
sheet index	revision sheet								

cage code 22526

Pro/E