

| | |
|-------------|---------------------|
| EDP NUMBER | FRONT SHELL PLATING |
| 051-26-0011 | BRIGHT TIN |
| 70665-1009 | BRIGHT NICKEL |

NOTES:

- CONNECTOR MATERIALS:
HOUSING AND INSERT-MOLDED STICKS ARE MADE OF GLASS FILLED LCP (LIQUID CRYSTAL POLYMER), U.L. 94 V-0, COLOR IS BLACK; TERMINALS ARE .018/(0.46) THICK PHOSPHOR BRONZE; TERMINAL PLATING IS .000030/(.00076) MINIMUM GOLD IN CONTACT AREA, AND .000100/(.00254) MINIMUM TIN ON P.C. TAILS, OVER NICKEL UNDERPLATE OVERALL.
- FRONT SHELL:
DRAW QUALITY STEEL, .020/(0.51) THICK;
PLATING: SEE TABLE
BRIGHT TIN: 150-250 MICROINCHES/(3.81-6.35 MICROMETERS) BRIGHT TIN OVER 50-150 MICROINCHES/(1.27-3.81 MICROMETERS) NICKEL OVER COPPER FLASH OVERALL (OPTIONAL).
BRIGHT NICKEL: 100-175 MICROINCHES/(2.54-4.44 MICROMETERS) BRIGHT NICKEL OVER 50 MICROINCHES/(1.27 MICROMETERS) MAXIMUM COPPER OVERALL.
- BACK SHELL:
DRAW QUALITY STEEL, .016/(0.41) THICK;
PLATING: 150-250 MICROINCHES/(3.81-6.35 MICROMETERS) BRIGHT TIN OVER 50-150 MICROINCHES/(1.27-3.81 MICROMETERS) NICKEL OVER COPPER FLASH OVERALL (OPTIONAL).
- ALL DIMENSIONS ARE SHOWN FOR REFERENCE ONLY UNLESS SPECIFIED OTHERWISE.
- THIS CONNECTOR CONFORMS TO PRODUCT SPECIFICATION PS-70660.
NOTE FOR LEAD FREE CONVERSION:
THE PRIMARY SHIPPING CARTON WILL BE LABELED "COMPLIANT TO ROHS DIRECTIVE 2002/95/EC AND ELV ANNEX II OF DIRECTIVE 2000/53/EC". CARTONS WITHOUT THIS LABEL MAY CONTAIN PRODUCT WITH LEAD.

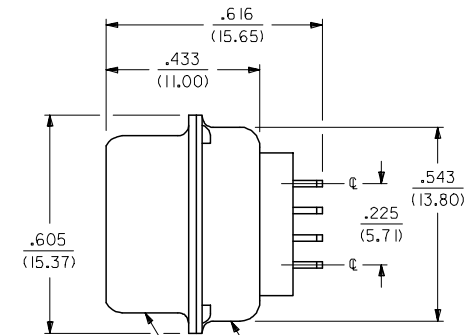
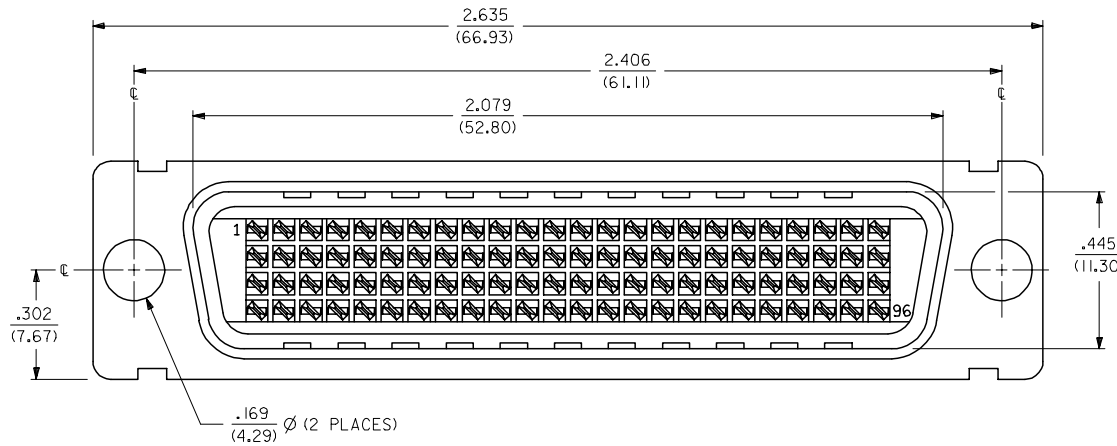
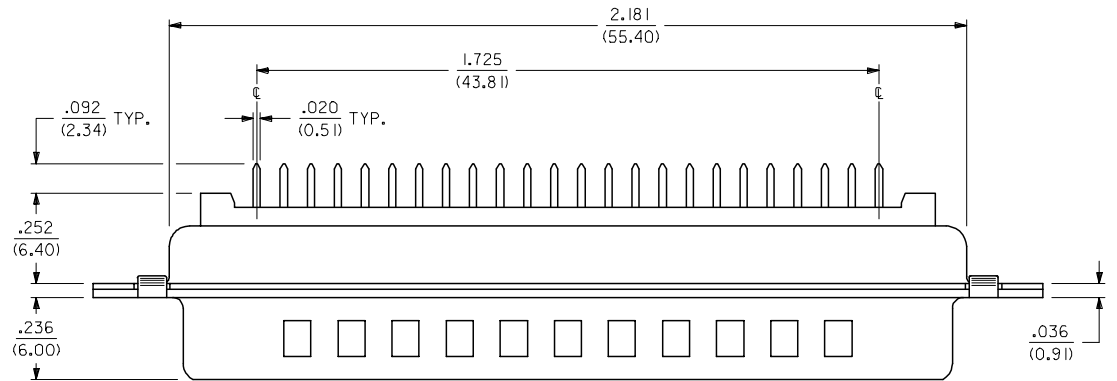

SEE NOTE #3

SEE NOTE #2

| | | | | | | | |
|--|--|---|-----------------|---|--------------------------------|---|--|
| ADD 70665-1009 EC NO: UCP2006-0666 DRWN:MSI:BARA 2006/02/06 CHKD:DMORGAN 2006/02/07 APPR:SMILLER 2006/02/09 REVISIONS | QUALITY SYMBOLS | GENERAL TOLERANCES (UNLESS SPECIFIED) | DIMENSION STYLE | SCALE | DESIGN UNITS | THIRD ANGLE PROJECTION | |
| | $\nabla=0$ $\nabla=0$ | mm INCH 4 PLACES ± --- ± --- 3 PLACES ± --- ± --- 2 PLACES ± --- ± --- 1 PLACE ± --- ± --- ANGULAR ±1/2° | IN/MM | 4:1 | INCH | | |
| | DRAWN BY DATE GLT 91/09/30 CHECKED BY DATE CAB 91/09/30 APPROVED BY DATE CAB 91/09/30 | DRAFT WHERE APPLICABLE MUST REMAIN WITHIN DIMENSIONS | | MATERIAL NO. SEE TABLE | DOCUMENT NO. SDA-70665-1001 | TITLE LFH, .075 PITCH, 96 CIRCUIT, VERTICAL I/O PLUG CONNECTOR | |
| | MOLEX INCORPORATED | SHEET NO. 1 OF 2 | | THIS DRAWING CONTAINS INFORMATION THAT IS PROPRIETARY TO MOLEX INCORPORATED AND SHOULD NOT BE USED WITHOUT WRITTEN PERMISSION | | | |

| | |
|-----|-----|
| 2 | D |
| 1 | F |
| SHT | REV |

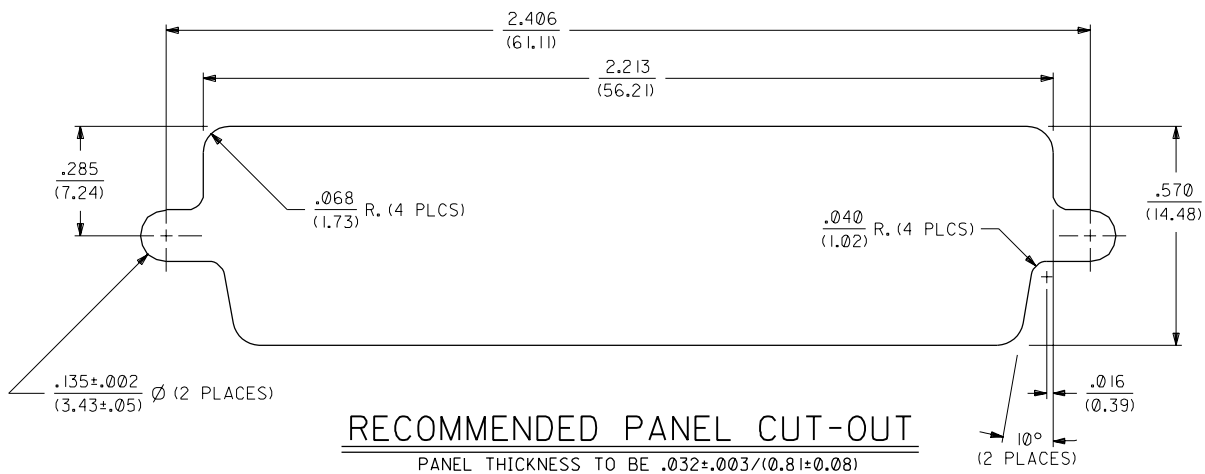

RECOMMENDED PANEL CUT-OUT
 PANEL THICKNESS TO BE $.032 \pm .003 / (0.81 \pm 0.08)$

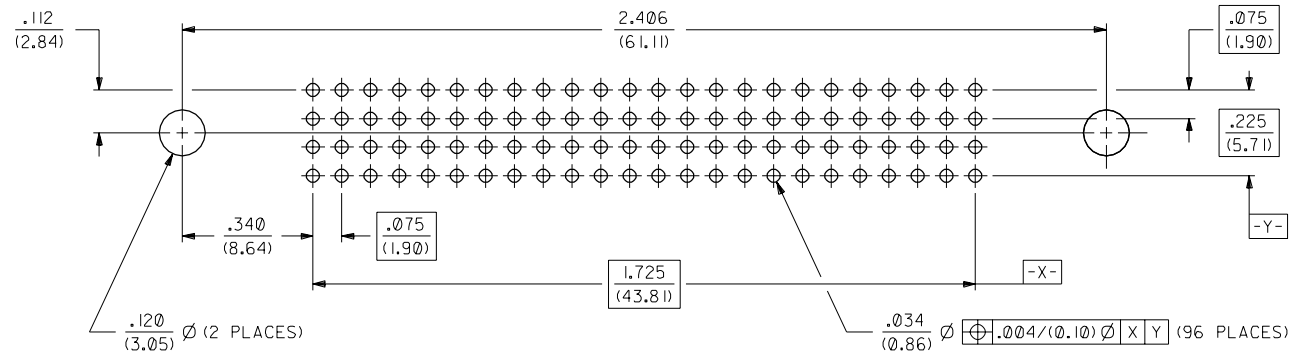

RECOMMENDED PCB AND MTG HOLE LAYOUT
 BOARD THICKNESS TO BE $.062 \pm .007 / (1.57 \pm 0.18)$

| | |
|---|--------------|
| D | SEE SHEET #1 |
|---|--------------|

| MFG. | SH. | REV. | LTR. | REVISIONS |
|------|-----|------|------|-----------|
|------|-----|------|------|-----------|

| | | | | | |
|---|--|---|--|---------------------------|---------------|
| DIMENSIONS SHOWN (METRIC) INCH | | ▽ = 0 ▼ = 0 | | REVISE ONLY ON CAD SYSTEM | |
| UNLESS OTHERWISE SPECIFIED TOLERANCES ANGULAR ± .0000 40° | | TITLE | | | |
| 3 PLACE ± .003 | | LFH, .075 PITCH, 96 CKT., VERTICAL I/O PLUG CONNECTOR (SALES DRAWING) | | | |
| 2 PLACE ± — ± 0.08 | | MOLEX INCORPORATED | | SHEET NO. 2 | DATE 06/05/96 |
| 1 PLACE — ± — | | L1SLE.ILL. 60532 | | U.S.A. | |
| DRAFT WHERE APPLICABLE MUST REMAIN WITHIN DIMENSIONS | | PART NO. SEE SHEET #1 | | DRWG. NO. SDA-70665-1001 | |
| DRAWN BY SCHMIDGALL | | CHK'D BY GWF | FILE NAME SD7066SK3 | | DIV. DA |
| APP'D BY GWF | | SCALE 4:1 | THIS DRAWING CONTAINS INFORMATION THAT IS PROPRIETARY TO MOLEX INC. AND SHOULD NOT BE USED WITHOUT WRITTEN PERMISSION. | | SIZE C |