

## Adapter plate - VS-ADP16-VS15 - 1652143

Please be informed that the data shown in this PDF Document is generated from our Online Catalog. Please find the complete data in the user's documentation. Our General Terms of Use for Downloads are valid (<http://download.phoenixcontact.com>)



Adapter plate, size B16, reinforced, including panel mounting frame with DSUB 15 protective cover and without contact insert



### Key commercial data

Packing unit	1 1
Weight per Piece (excluding packing)	51.9 GRM
Custom tariff number	85369010
Country of origin	Germany

### Technical data

#### Ambient conditions

Ambient temperature (operation)	-20 °C ... 80 °C
Degree of protection	IP54

#### Material data

Inflammability class according to UL 94	HB
Material	PA
Sealing material	TPE
Seal material	TPE

### Classifications

#### eCl@ss

eCl@ss 4.0	27140816
eCl@ss 4.1	27140816
eCl@ss 5.0	27189239
eCl@ss 5.1	27189239

# Adapter plate - VS-ADP16-VS15 - 1652143

## Classifications

eCl@ss

eCl@ss 6.0	27144001
eCl@ss 7.0	27144001

ETIM

ETIM 2.0	EC000007
ETIM 3.0	EC000007
ETIM 4.0	EC000007
ETIM 5.0	EC002309

UNSPSC

UNSPSC 6.01	31261501
UNSPSC 7.0901	31261501
UNSPSC 11	31261501
UNSPSC 12.01	31261501
UNSPSC 13.2	31261501

## Drawings

Dimensioned drawing

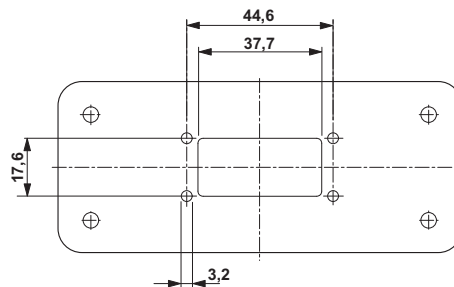

Panel cutout

## Adapter plate - VS-ADP16-VS15 - 1652143

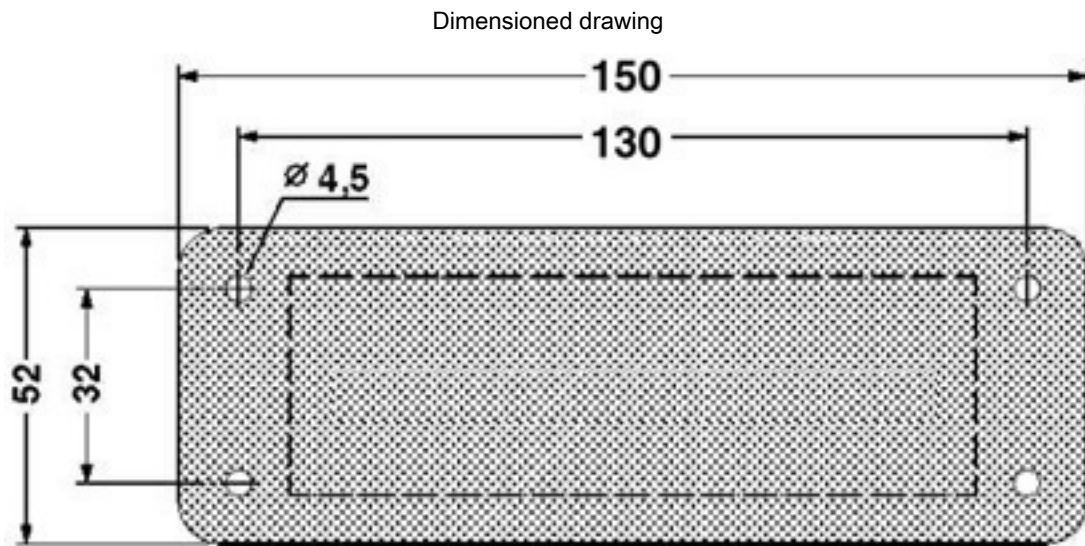

Adapter plate