

PART NUMBER	REV	FIRST USED
567183-9	C	354500-1

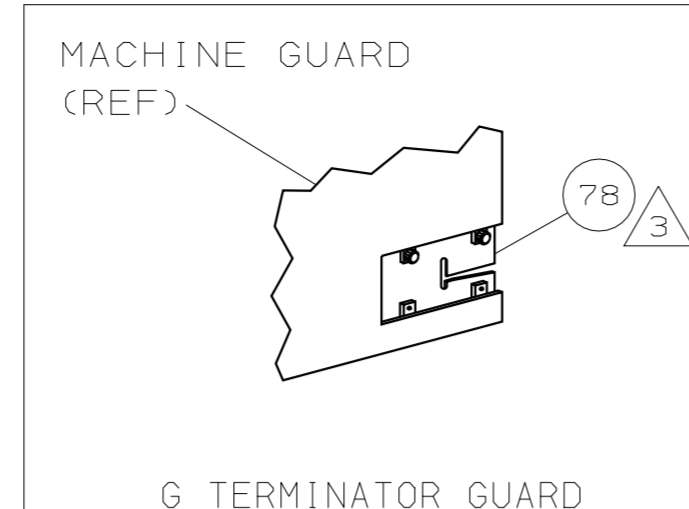
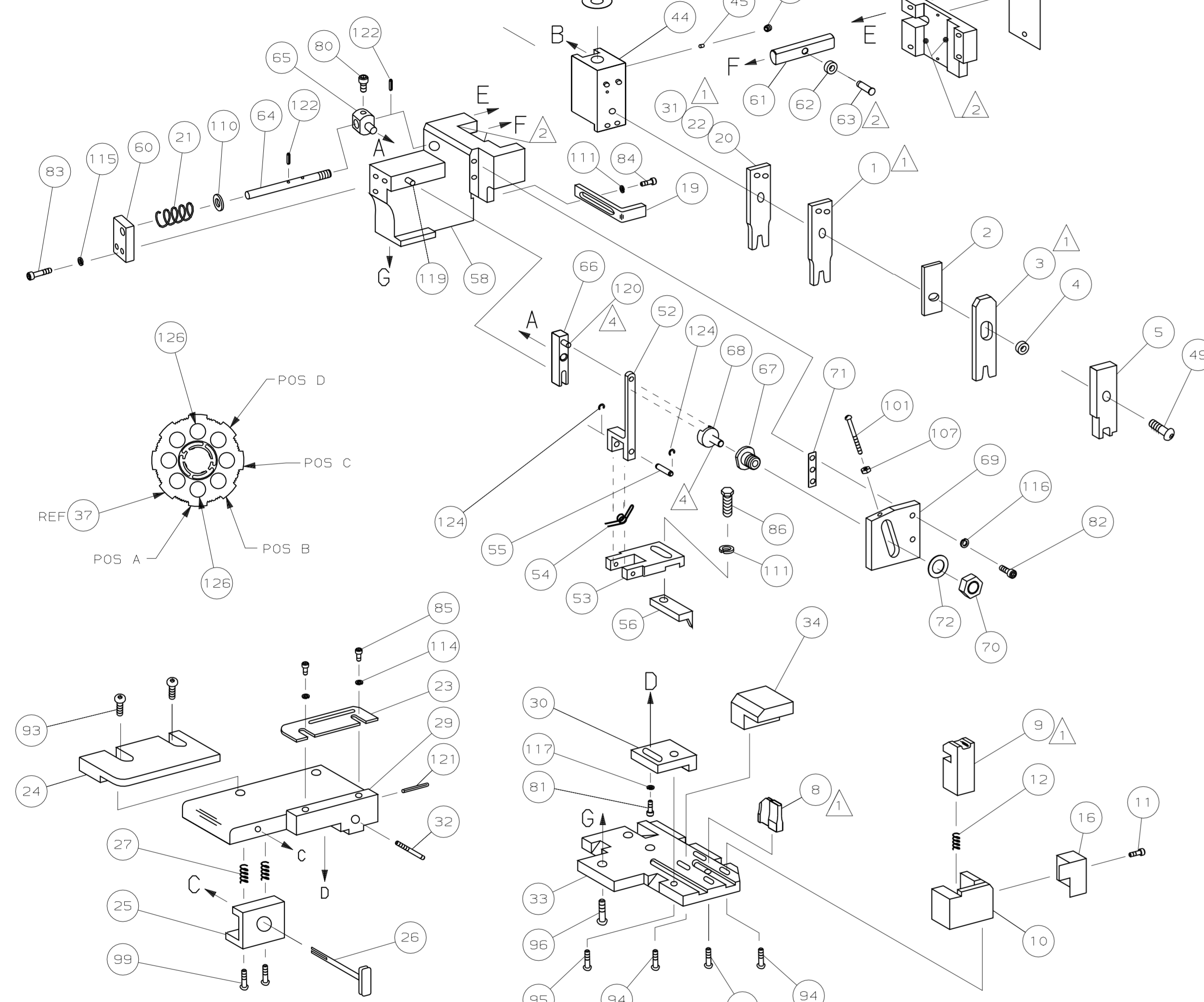
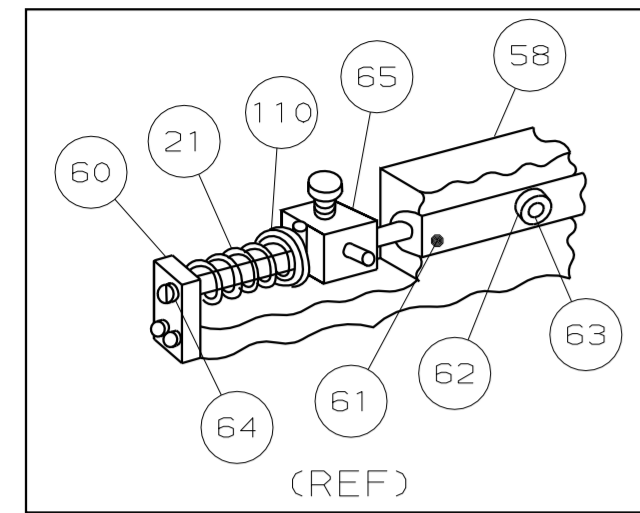

TERMINAL NAME: AMP-IN™ TERMINAL		CRIMPING DATA			
VISIBLE PAD LTR	WIRE SIZE	CRIMP HEIGHT	WIRE SIZE		
770060	18-12	A .110 ±.005 [2.79 ±.13 mm]	18-12		
794013	USED	B NOT	USED		
	USED	C NOT	USED		
	USED	D NOT	USED		
WIRE	SIZE	TYPE	RANGE		
.110	[2.79mm]	0	18-12		
INSUL	SIZE	TYPE	RANGE		
.155	[3.94mm]	F	.090-.150		
WIRE STRIP LENGTH	TERM APPL SPEC	FEED	APPL INSTRUCTION	SET UP GAGE	LAYOUT
.189-.221	114-1016	.560	408-8040	458637-1	1262-A1

REF	QTY	MODEL	MECH-PRE FEED	DESCRIPTION	ITEM NO
REF	-	B	22594-8	NUT, HEX (1/2-20)	70
REF	-	B	240628-1	PLATE, ADJUSTMENT	69
REF	-	B	240626-1	SHAFT, PIVOT	68
REF	-	B	240633-1	BUSHING	67
REF	-	A	455680-1	LEVER, INTERMEDIATE	66
REF	-	B	240629-1	BLOCK, PIVOT	65
REF	-	A	240632-2	SCREW, ADJ FEED ROD	64
REF	-	B	240659-3	PIN, CAM ROLLER	63
REF	-	B	240658-1	ROLLER, CAM	62
REF	-	B	454398-2	ROD, FEED	61
REF	-	A	454178-1	GUIDE, FEED ROD	60
REF	-	C	454220-1	CAP, RAM	59
REF	-	D	454485-1	HOUSING	58
					57
1	-	B	458537-2	PAWL, FEED	56
REF	-	B	240624-1	PIN, FEED FINGER	55
REF	-	B	691499-1	SPRING, FEED FINGER	54
REF	-	B	690541-1	HOLDER, FEED FINGER	53
REF	-	A	455679-2	LEVER, TERMINAL FEED ARM	52
					51
					50
1	-	A	7-21002-9	BOLT, CRIMPER (5/16x1.00)	49
1	-	B	690602-6	CAM, PRE-FEED 1 5/8 ST	48
					47
1	-	B	459456-2	APPLICATOR, BASIC (SUBASSY)	46
1	-	A	690191-1	PLUG, NYLON	45
1	-	C	455673-5	RAM	44
1	-	A	690125-1	WASHER, LAMINATED	43
1	-	A	690124-3	WASHER, RAM	42
					41
1	-	A	23241-6	BALL, STEEL	40
1	-	A	690170-1	SPRING, COMPRESSION	39
1	-	C	690142-5	DISC, INSULATION	38
1	-	D	354777-1	WIRE DISC, PLASTIC	37
1	-	A	22480-5	WASHER, SPRING	36
1	-	B	690212-1	POST, RAM	35
1	-	B	469465-1	STOP, WIRE	34
REF	-	D	455675-1	PLATE, BASE	33
1	-	A	690432-3	SCREW, ADJUSTMENT	32
1	-	B	3-456408-4	CRIMPER, WIRE	31
REF	-	B	455689-1	BLOCK, STRIP GUIDE ADJ	30
1	-	C	455671-1	PLATE, STRIP GUIDE	29
					28
2	-	A	1-22284-0	SPRING, DRAG	27
1	-	B	690546-1	LEVER, DRAG RELEASE	26
1	-	B	240792-1	DRAG, TERMINAL	25
1	-	D	6-690440-5	GUIDE, STRIP (REAR)	24
1	-	A	690438-1	GUIDE, STRIP (FRONT)	23
1	-	B	2-456408-6	CRIMPER, WIRE	22
REF	-	A	4-22284-9	SPRING, FEED RETURN	21
1	-	B	2-456408-5	CRIMPER, WIRE	20
1	-	B	1-690472-3	STRIPPER	19
					18
					17
1	-	B	691667-1	GUARD, CHIP (FRONT)	16
					15
					14
					13
1	-	A	3-22280-3	SPRING, SHEAR	12
1	-	B	690461-7	STOP, SHEAR	11
1	-	C	1-690459-0	HOLDER, SHEAR (FRONT)	10
1	-	C	454276-5	SHEAR, FLOAT (FRONT)	9
1	-	C	4-803653-9	ANVIL	8
					7
					6
1	-	C	2-455889-1	DEPRESSOR, SHEAR (FRONT)	5
1	-	B	238011-8	SPACER, BLOCK CRIMPER	4
1	-	C	3-683453-2	CRIMPER, INSULATION	3
1	-	C	455888-9	SPACER, CRIMPER	2
1	-	C	815664-2	CRIMPER, WIRE	1

- 1 RECOMMENDED SPARE PARTS.
- 2 GREASE LIGHTLY.
- 3 GUARD MUST BE IN PLACE WHEN OPERATING APPLICATOR IN A BENCH MACHINE.
- 4 LUBRICATE DAILY USING NO. 20 MACHINE OIL.
- 5. ITEMS WITH QTY OF REF SPECIFIED (EXCEPT ITEM 78) ARE USED ON ITEM 46.
- 6 CRIMP HEIGHT TO BE MEASURED OVER CENTER BARREL. NOSE CRIMP HEIGHT TO BE .055±.002 FOR 14 GA WIRE, .043±.002 FOR 16 & 18 GA WIRE & .085±.002 FOR 12 GA WIRE. SEE NOTE 9.
- 7 LOCATE ITEM 19 BETWEEN ITEM 1 & ITEM 3.
- 8 FOR USE IN PRINTED CIRCUIT BOARD WITH A Ø.125 HOLE.

CRIMP HT	WIRE SIZE	CRIMPER NO.	ITEM NO.
.085	12	3-456408-4	31
.055	14	2-456408-5	20
.043	16 OR 18	2-456408-6	22

SET UP APPLICATOR FOR 18 OR 16 WIRE (ITEM 22). (ITEMS 20 & 31) TO BE SHIPPED WITH APPLICATOR.

- 9 12 GA WIRE TO BE USED WITH TERMINAL 794013 ONLY.
- 10 SPARE TOOLING KIT 7-567183-7.
- 11 TERMINAL 770060 FOR 14AWG-18AWG ONLY

QTY	REF	U/M	DWG SIZE	PART NO	DESCRIPTION	ITEM NO
1	-	A		21009-2	SCR, SKT SET (1/4-20x.25 LW) RAM	103
2	-	A		21017-2	SCR, DRIVE (#2x.19) ID PLATE	102
REF	-	A		6-23715-5	SCR, PAN HD (6-32x1.50) FEED ADJ	101
1	-	B		461264-1	PLATE, IDENTIFICATION	100
2	-	A		5-21006-6	SCR, SET (10-32x.75) DRAG	99
1	-	A		22733-8	SCR, BHC (8-32x.38 LW) ANVIL	98
REF	-	A		2-21002-9	SCR, BHC (10-32x.75) CAP	97
REF	-	A		2-22733-8	SCR, BHC (1/4-20x.62) HOUSING	96
REF	-	A		2-21002-7	SCR, BHC (10-32x.50) 5G ADJ BLOCK	95
4	-	A		2-21002-2	SCR, BHC (8-32x.50) SHEAR	94
2	-	A		2-21002-3	SCR, BHC (8-32x.62) R STP GDE	93
						92
1	-	A		1-21002-7	SCR, BHC (6-32x.38) CAM	91
						90
						89
						88
						87
1	-	A		2-22603-0	SCR, HEX HD (8-32x.31) FEED FINGER	86
2	-	A		1-21000-3	SCR, SHC (4-40x.25) F ST GUIDE	85
1	-	A		2-21000-7	SCR, SHC (8-32x.50) STRIPPER	84
REF	-	A		3-21000-7	SCR, SHC (10-32x.75) FEED ROD GD	83
REF	-	A		3-21000-6	SCR, SHC (10-32x.62) FD ADJ BLK	82
1	-	A		3-21000-4	SCR, SHC (10-32x.38) 5G ADJ BL	81
REF	-	A		3-21000-4	SCR, SHC (10-32x.38) PIVOT BLK	80
						79
REF	-	B		679532-1	INSERT, GUARD	78
						77
						76
						75
1	-	A		690603-1	SPRING, ASSIST	74
1	-	A		23030-1	SCR, SKT CAP (6-32x.25) CP DSC	73
REF	-	A		458109-1	WASHER, SPECIAL	72
REF	-	A		690517-1	SPACER	71
						70
						69
						68
						67
						66
						65
						64
						63
						62
						61
						60
						59
						58
						57
						56
						55
						54
						53
						52
						51
						50
						49
						48
						47
						46
						45
						44
						43
						42
						41
						40
						39
						38
						37
						36
						35
						34
						33
						32
						31
						30
						29
						28
						27
						26
						25
						24
						23
						22
						21
						20
						19
						18
						17
						16
						15
						14
						13
						12
						11
						10
						9
						8
						7
						6
						5
						4
						3
						2
						1

THIS DRAWING IS A CONTROLLED DOCUMENT

THIS DRAWING IS UNPUBLISHED. FEB 5, 1988 RELEASED FOR PUBLICATION BY AMP INCORPORATED. ALL INTERNATIONAL RIGHTS RESERVED. © COPYRIGHT 1988

LOC A  
DIST 66

DIMENSIONS IN INCHES. DO NOT SCALE PRINT. TOLERANCES UNLESS OTHERWISE SPECIFIED:  
 2 PLC DEC ±  
 3 PLC DEC ±  
 4 PLC DEC ±  
 ANGLES ±  
 SURF TEXTURE: ✓  
 REMOVE BURRS, BREAK SHARP EDGES R.015 MAX

MATL - HT TR - FIN -  
 DR 1-19-98 APP 1-19-08  
 D. SALTZER J. DODDS  
 CHK 1-21-97 REL 2/3/98  
 C. ERISMAN B. MORGAN

AMP AMP Incorporated Harrisburg, PA 17105-3608

NAME SIDE FEED HDM APPLICATOR MACHINE REF MINI APPL  
 SCALE - DWG NO 567183-9 SHEET 1 OF 1 REV C

CAGE CODE 00779 CUSTOMER AND ASSEMBLY DRAWING RESTRICTED TO