

THIS DRAWING IS A CONTROLLED DOCUMENT FOR THE AMP INC. IT IS SUBJECT TO CHANGE AND THE USER IS ADVISED THAT THE LATEST REVISION SHOULD BE CONSULTED FOR THE LATEST REVISION.

THIS INFORMATION IS CONFIDENTIAL AND IS TO BE KEPT AS SUCH TO AVOID DISCLOSURE TO ANY OTHER PARTY WITHOUT WRITTEN AUTHORIZATION FROM AMP INCORPORATED, HARRISBURG, PA.

10

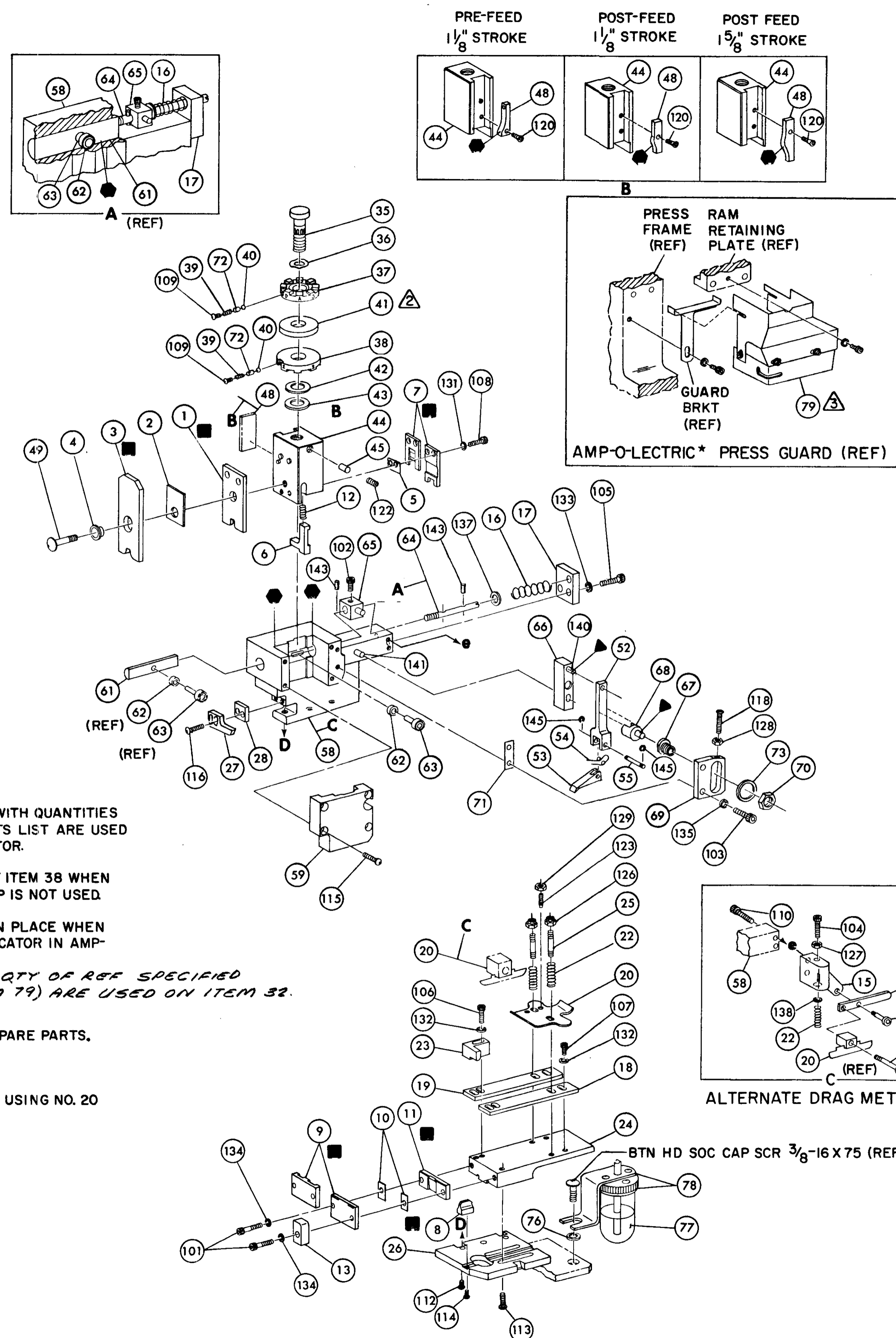

NOTES:

1 ONLY THE ITEMS WITH QUANTITIES SPECIFIED ON PARTS LIST ARE USED ON THIS APPLICATOR.

△ USED IN PLACE OF ITEM 38 WHEN INSULATION CRIMP IS NOT USED.

△ GUARD MUST BE IN PLACE WHEN OPERATING APPLICATOR IN AMP-O-LECTRIC PRESS.

4. PARTS WITH QTY OF REF SPECIFIED (EXCEPT ITEM 79) ARE USED ON ITEM 32.

KEY:

■ RECOMMENDED SPARE PARTS.

▲ LUBRICATE DAILY USING NO. 20 MACHINE OIL.

⦿ GREASE LIGHTLY.

AMP 3076-2 (8-73)

REF	QTY	PART NO	DESCRIPTION	ITEM NO
REF	145	21045-3	RING, RETAINING 'C' (.187 DIA) FEED PIN	59
REF	144	454220-1	CAP, RAM	58
REF	143	5-21028-1	PIN, SLOT SPG (.12 DIA X .50) FD ADJ ROD	57
REF	142			56
REF	141	1-21030-7	PIN, DOWEL (.187 DIA X 1.50) HOUSING	55
REF	140	1-21030-1	PIN, DOWEL (.187 DIA X .50) LEVER	54
	139			53
	138	22260-5	WASHER, FLAT (NO 6) DRAG SPRING	52
REF	137	21899-4	WASHER, FLAT (5/16 DIA) SCR ADJ	51
	136			50
REF	135	21024-5	WASHER, LOCK (NO 10) FEED ADJ PLATE	49
2	134	21024-5	WASHER, LOCK (NO 10) SHEAR PLATES	48
REF	133	21024-5	WASHER, LOCK (NO 10) FEED ROD GUIDE	47
4	132	21024-4	WASHER, LOCK (NO 8) STRIP GUIDE	46
2	131	21024-4	WASHER, LOCK (NO 8) SHEAR BLADE	45
	130			44
2	129	21018-4	NUT, HEX MACH (4-40) DRAG	43
REF	128	21068-5	NUT, HEX MACH (6-32) FD ADJ PLATE	42
	127	21018-7	NUT, HEX MACH (10-32) DRAG SPRING	41
2	126	21022-2	NUT, HEX SELF-LKG (8-32) DRAG STUD	40
	125	5-21004-7	SCR, SKT HD SHLD (250 DIA X .25) DRAG ARM	39
	124	21004-5	SCR, SKT HD SHLD (250 DIA X 1.00) DRAG	38
2	123	4-21078-8	SCR, SKT SET OVAL POINT (4-40 X .75) DRAG	37
1	122	21009-2	SCR, SKT SET (1/4-20 X 25) (LOC-WEL) RAM	36
	121			35
1	120	2-21003-0	SCR, FLAT HD SKT CAP (6-32 X .50) CAM	34
	119			33
REF	118	3-21064-2	SCR, RD HD MACH (6-32 X 1.50) FEED ADJ	32
	117			31
2	116	2-21002-2	SCR, BTN HD SKT CAP (8-32 X .50) STRIPPER	30
REF	115	2-21002-9	SCR, BTN HD SKT CAP (10-32 X .75) HSG CAP	29
1	114	2-2733-8	SCR, BTN HD SKT CAP (8-32 X .38) (LOC-WEL) ANVIL	28
4	113	3-21002-3	SCR, BTN HD SKT CAP (1/4-20 X .50) STR GDE PL	27
REF	112	1-24073-9	SCR, BTN HD SKT CAP (1/4-20 X .75) BASE PL	26
	111			25
	110	2-21000-4	SCR, SKT HD CAP (6-32 X 1.00) DRAG ADAPTOR	24
2	109	23030-1	SCR, SKT HD CAP (6-32 X .25) (LOC-WEL) CP DISC	23
2	108	2-21000-8	SCR, SKT HD CAP (8-32 X .62) SHEAR BLADE	22
3	107	2-21000-6	SCR, SKT HD CAP (8-32 X .38) STRIP GUIDE	21
1	106	2-21000-6	SCR, SKT HD CAP (8-32 X .38) STRIP GUIDE	20
REF	105	3-21000-7	SCR, SKT HD CAP (10-32 X .75) FD ROD GUIDE	19
	104	3-21000-9	SCR, SKT HD CAP (10-32 X 1.00) DRAG SPRING	18
REF	103	3-21000-6	SCR, SKT HD CAP (10-32 X .62) FD ADJ PLATE	17
REF	102	3-21000-4	SCR, SKT HD CAP (10-32 X .38) PIVOT BLK	16
2	101	3-21000-8	SCR, SKT HD CAP (10-32 X .88) SHEAR PLATE	15
REF	79	455745-1	GUARD, WINDOW	14
	78	465184-9	LUBRICATOR ASSY	13
	77	455985-1	OIL, LUBRICATING	12
	76	454406-1	SPACER, LUB BRACKET	11
	75			10
	74			9
REF	73	458109-1	WASHER, FLAT (SPECIAL)	8
2	72	690603-1	SPRING, ASSIST	7
REF	71	690517-1	SPACER	6
	70	22594-8	NUT, HEX	5
	69	240628-1	PLATE, ADJ	4
	68	240626-1	SHAFT, PIVOT	3
	67	240633-1	BUSHING	2
	66	455680-1	LEVER, INTERMEDIATE	1
	65	240629-1	BLOCK, PIVOT	
	64	240632-2	SCREW, ADJ	
	63	240659-3	PIN, CAM ROLLER	
	62	240658-1	CAM, ROLLER	
REF	61	454398-1	ROD, FEED	
	60			
	59			

CRIMPING DATA				APPLICATOR WILL APPLY	
PAD LTR	CRIMP HEIGHT	WIRE SIZE	WIRE LENGTH		
A	.050	20			62074
B	.048	22			62344
C	.044	24			
D	NOT USED				

CRIMP	SIZE	TYPE	FEED	APPL INST
WIRE	.070	F		A18039
INSUL	.140	0*	.934	
WIRE RANGE	24-20	INSULATION RANGE	.100-.103	PRESS NO
REMARKS				565435-5

AMP-O-LECTRIC PRE FEED

* INSUL. BBL. TO BE CRIMPED TO A .140 O.D. (INS. TO BE FREE INSIDE INSUL. BBL.)

REMARKS	NO	REV
APPL USED ON MACHINE PART NO	MACH SERIAL NO	DISTRIBUTION
CUSTOMER NAME	APPL SERIAL NO	ORIGINAL
ADDRESS	PURCHASE ORDER	CUSTOMER COPY
CITY	ENG APP	FIELD ENG COPY

F	0150-6987-96	DATE	7/26	SETUP PAGE	10-1
E	ECN A-246190	DATE	4/90	258638-1567	
D	ECN A157685	DATE	11-88	DR 627721	
C	REV PER ECN R-3477	DATE	11/11/88	11/11/88	
B	REV PER ECN R-3052	DATE	11/11/88	11/11/88	
A	REV PER ECN R-9003	DATE	11/11/88	11/11/88	
O1	APPL. ITR. 2:44 R831	DATE	12/7/77		

LOC A D NO 466182-2 REV F

NAME MINIATURE QUICK CHANGE APPLICATOR.

END FEED (PIN RECPT.)