

RECOMMENDED PANEL MOUNTING

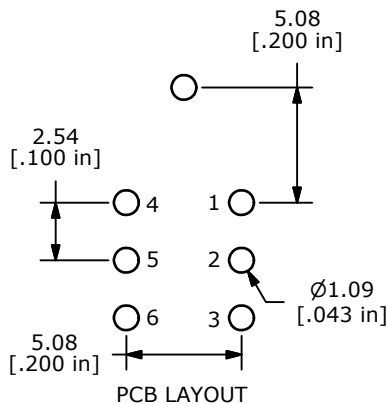

PCB LAYOUT

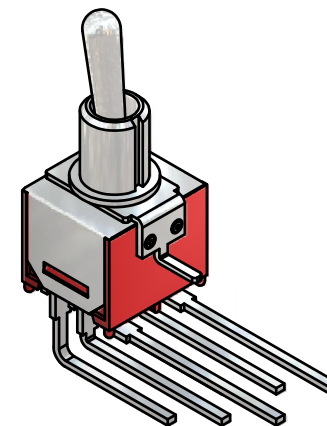
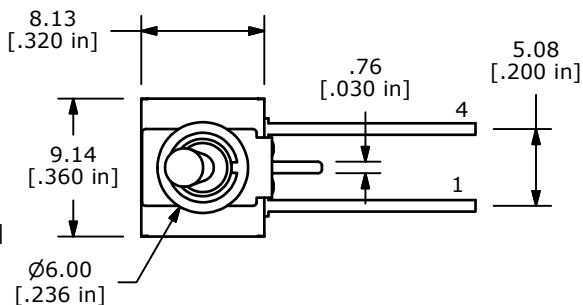

ISOMETRIC

SWITCH FUNCTION		
POS. 1	POS. 2	POS. 3
ON	NONE	ON
2-3, 5-6	N/A	2-1, 5-4

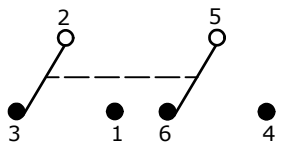

CIRCUIT: DPDT

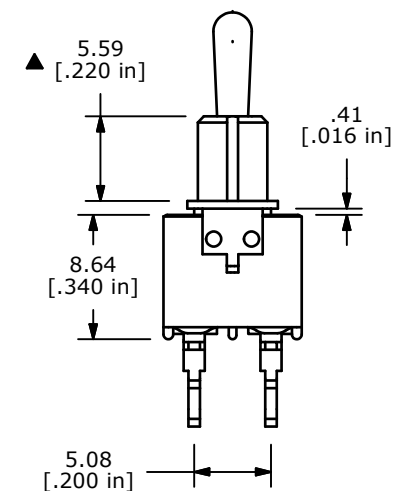
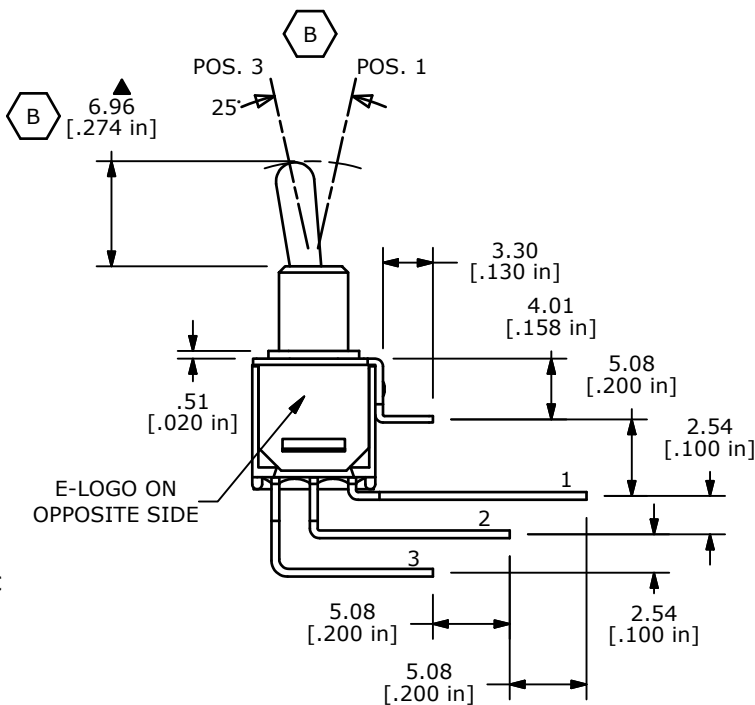

- NOTE:
- ALL DIMENSIONS IN MM [INCH]
 - GENERAL TOLERANCE: X.X=±0.4
X.XX=±0.25
 - TERMINAL NUMBERS FOR REF ONLY
 - ▲ PLATING MATERIAL: SILVER
 - RATING: 3 AMPS @ 120VAC OR 28VDC; 1 AMPS @ 250VAC
 - ELECTRIC LIFE: 30,000 MAKE-AND-BREAK CYCLES AT FULL LOAD.
 - INSULATION RESISTANCE: 1,000 MEGA-OHM MIN.
 - DIELECTRIC STRENGTH: 1,000 V RMS @SEA LEVEL.
 - OPERATING TEMP.: -30°C to 85°C
 - ▲ DENOTES CRITICAL PARAMETER.
 - 2002/95/EC (ROHS) COMPLIANT



B	19849	CHANGE POS. REP. & ACTUATOR DIM	4/15/11	BGL
A	19698	NEW PART RELEASE	2/22/11	BGL
REV	PCR NO	DESCRIPTION	DATE	BY

TITLE 200MDP1T3B4M7QE				
SCALE 2:1	DATE 2/22/2011	DR BGL	DWG T221073	REV B

THE INFORMATION CONTAINED IN THIS DOCUMENT IS PROPRIETARY TO E-SWITCH AND IS NOT TO BE COPIED OR TRANSFERRED