

© COPYRIGHT 1968 BY AMP INCORPORATED, HARRISBURG, PA.
 ALL INTERNATIONAL RIGHTS RESERVED. AMP INCORPORATED PRODUCTS
 COVERED BY U.S. AND FOREIGN PATENTS AND/OR PATENTS PENDING.

REVISIONS						
P	F	ZONE	LTR	DESCRIPTION	DATE	APPROVED
	✓		B	REDRAWN	9-13-79	M.S.
	✓		C	OBSOLETE -2 ECN 53622	11-13-86	R.B.
	✓		D	REV PER E.C.N. S-3960	4-13-87	R.B.

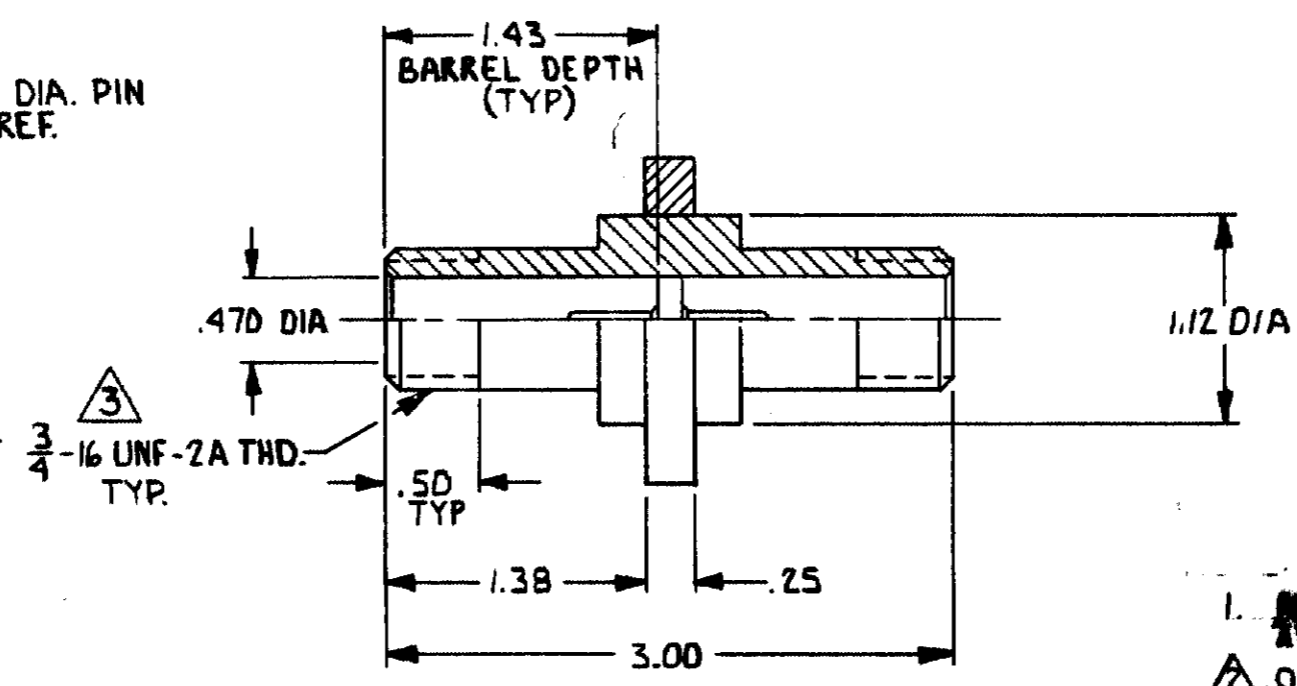
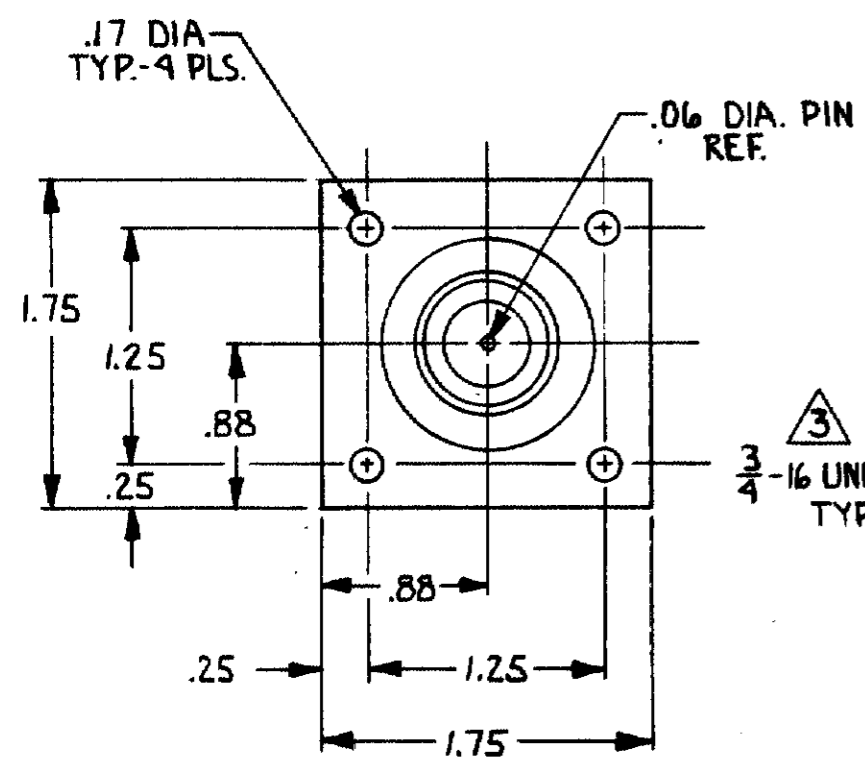

- 1. RECEPTACLE TO MATE WITH AMP LGH-2 LEAD ASSEMBLY AVAILABLE SEPARATELY.
- △ OBSOLETE PART NUMBER.
- △ PER FEDERAL STANDARD H-28 3WIRE METHOD. DIMENSION OVER WIRES TO BE: .7474-.7654.

				UNLESS OTHERWISE SPECIFIED DIMENSIONS ARE IN INCHES. TOLERANCES: .00 ± .03 .000 ± .015 ANGLES ±		CONTRACT NO		PART NO	
				MATERIAL		DR <i>A. Magan</i> 9-13-79		AMP INCORPORATED Elizabethtown, Pa.	
				FINISH		CHK		NAME	
				GLASS EPOXY		APPD <i>M. Mauldin</i> 9/13/79		LGH-2 RECEPTACLE (FOR BULKHEAD APPLICATION)	
				NATURAL		APPD		SIZE	
						DESIGN APPD <i>J.W. Gray</i> 9/30/68		CODE IDENT NO	
						OTHER APPD		DRAWING NO	
P/N		DESCRIPTION		NEXT ASSY		FINAL ASSY		B 00779	
850735-2		RECEPTACLE (PIN-GOLD PLATED)						850735	
850735-1		RECEPTACLE (PIN-TIN PLATED)						SCALE 1:1	
				NEXT ASSY		USED ON		SHEET 1 OF 1	
				QTY REQD		APPLICATION			