

1 Verify the kit contents

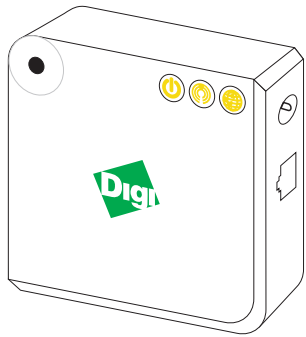

ConnectPort X2e SE

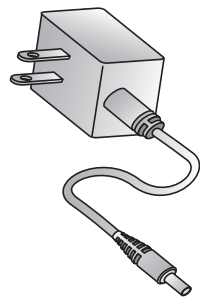

Power supply

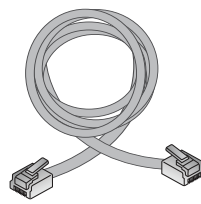

Ethernet cable



Quick Start Guide

ConnectPort® X2e
Smart Energy

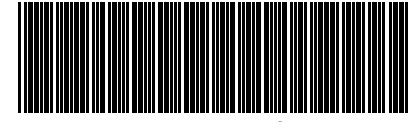

90001262-88 G

2 Write down device information

Write down the following information (located on the back of the device), which you will use in step 5.

Serial Number: _____

EUI64: _____

Install Code: _____

NOTE: The serial number is also the Ethernet MAC address.

Model: ConnectPort X2e SE
Part Number: X2E-Z1C-E1-A
Serial Number: 00409D 50E9BB
EUI64: 0013 A200 526B 1410
Install Code: ABCD 1234 ABCD 1234

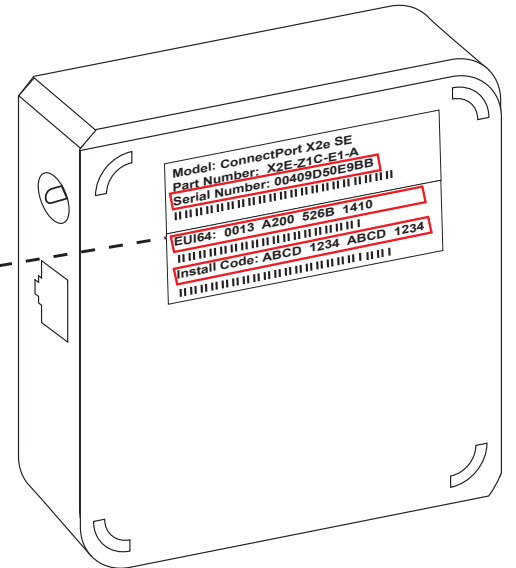

3 Connect the hardware

Connect the power supply. The Power LED lights green and the Network LED blinks orange.

NOTE: Once the device is connected to Device Cloud, the Network LED changes to green.

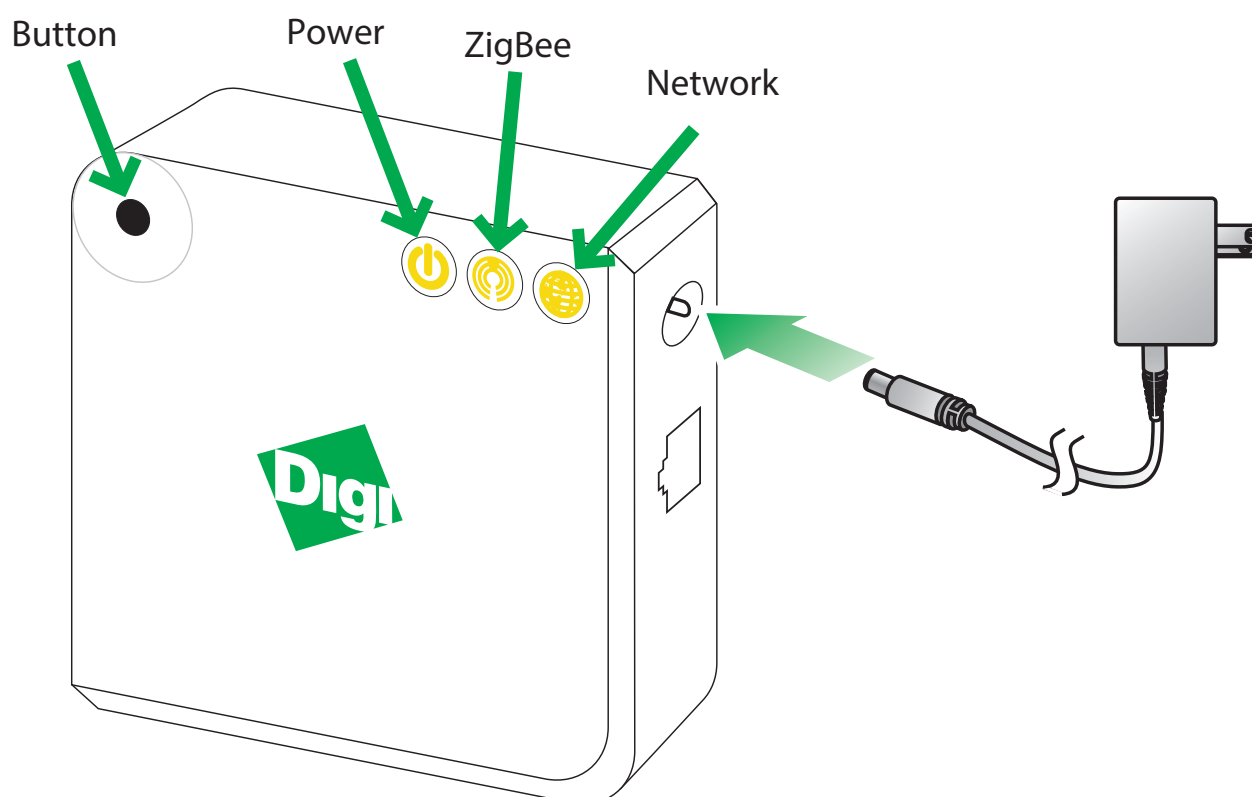

4 Add the router to the network (router models only)

This step is for router models only. If you have a coordinator model, proceed to step 5.

Add the router variant to the Smart Energy network. Contact the utility company or owner of the Smart Meter if you are unsure how to add a router to the network.

NOTE: Make sure the router is powered ON when you add it to or remove it from a Smart Energy network.

5 Connect to Device Cloud and form a Smart Energy network

- a Go to devicecloud.digi.com.
- b Sign up or log into your Device Cloud account as follows:
 - New users: Click **Sign Up** and create a free account. You can upgrade at any time.
 - Existing users: Log in with your username and password.
- c To add your gateway to the device list, in Device Cloud click **Device Management > Devices**.
- d Click **Add Devices**. From the Add Devices window:
 - To automatically discover the gateway: Click **Discover** to discover gateways on the local LAN/network.
 - To manually add the gateway: Next to the MAC address field, enter the gateway MAC address (for example: 00409D:XXXXXX) and click **Add**.
- e To form or provision a Smart Energy Network, go to <https://digi-se.appspot.com> and log in using your Device Cloud credentials, then proceed as follows:
 - 1 Navigate to the **Debug** tab.
 - 2 Select a gateway from the **Gateway** drop-down menu.
 - 3 Select the **RPC_ZigBee_Interface** menu (on the left).
 - 4 Click **add_device**.
 - 5 Type the EUI64 address and install code for the device.
 - 6 Click **Execute**.
- f To display device readings and related data in App Spot, navigate to **Network > Tree** or to **Network > In-Home Display**.

6 Next steps

For more details about adding devices, go to: https://digi-se.appspot.com/edocs/getting_started/adddevices.html.

For more details about Device Cloud, go to:

- User guide: <http://ftp1.digi.com/support/documentation/html/90001150/index.html>

- Programming guide: <http://ftp1.digi.com/support/documentation/html/90002008/index.html>

7 ConnectPort X2e LEDs

• Power

Status	Description
OFF	No power
Solid green	Device is powered

• ZigBee

Status	Description
OFF	Radio is disabled
Blinking green (slow)	Searching for other ZigBee devices on the network
Blinking green (fast)	Establishing a Smart Energy network
Solid green	Connected to a Smart Energy network

• Network

Status	Description
OFF	Powered OFF
Blinking yellow (slow)	Powered ON, no Wi-Fi link
Blinking yellow (fast)	Wi-Fi link, no IP address
Solid yellow	IP address assigned
Blinking green (slow)	Attempting a connection to Device Cloud
Blinking green (fast)	Device Cloud server found, authenticating
Solid green	Connected to Device Cloud

For help, call:
U.S. or Canada: 866.765.9885
Worldwide: +1 801.765.9885

Or visit us on the web:
Support: www.digi.com/support/eservice
Forums: www.digi.com/support/forum/