

NOTES: UNLESS OTHERWISE SPECIFIED;

1 INTERPRET THIS DRAWING IN ACCORDANCE WITH ANSI Y14.5M-1982.

2 MATERIAL: NYLON

3 APPROXIMATE WEIGHT: 2.3 GRAMS

4 THIS PART SNAP FITS INTO CATALOG NUMBER RSMDEX-1 AND WILL SEPARATE FROM IT WITH A FORCE NOT GREATER THAN 11 POUNDS (48.9 N) AND NOT LESS THAN 3 POUNDS (13.3 N).

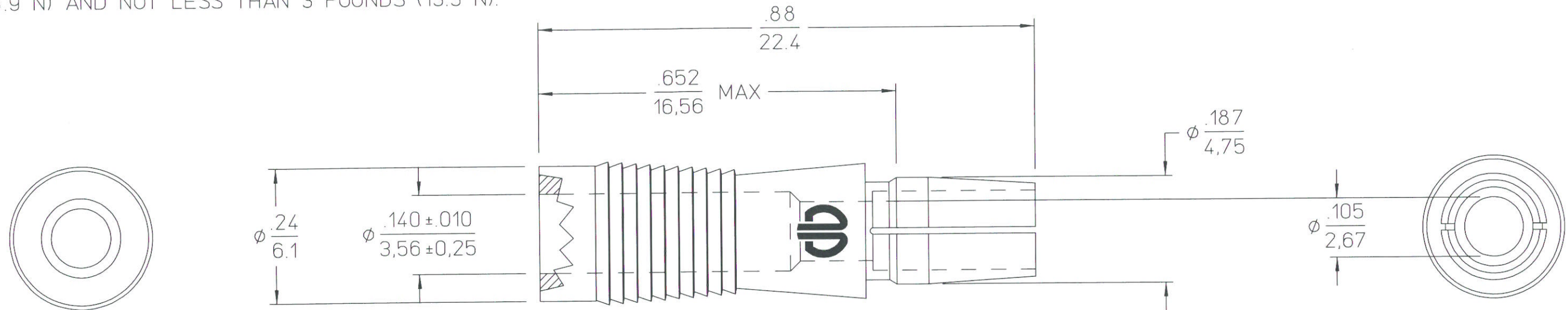

COLOR TABLE

CATALOG NO.	COLOR
RSCDEX-2	NATURAL (CLEAR TO WHITE)
RSCDEX-5	BLACK
RSCDEX-6	BLUE
RSCDEX-7	BROWN
RSCDEX-8	RED
RSCDEX-9	GREEN
RSCDEX-10	YELLOW
RSCDEX-11	VIOLET (PURPLE)
RSCDEX-12	GRAY
RSCDEX-13	ORANGE

REFERENCE:

SC55386 - RSMDEX-___
 SE52918 - SUB-MINIATURE COAX HYFEN
 SD57870 - SUB-MINIATURE COAX
 SD61512 - TRIM TRIO

ACCOMMODATES:

RCDX60-2 (SE52918)

SUPERSEDES:

SC55388
 AND SC60760-3

4	REDRAWN ON CAD WITHOUT CHANGE (ECN3129)	SMM	PJB	10/28/94
REV	REVISION DESCRIPTION	BY	CHKD	DATE

SUB-MINIATURE COAX SPLICE (PLUG) (SEPARABLE)			
CAT NO RSCDEX-___ (SEE TABLE)			
DWG RELEASED TO CENTRAL FILE 11-1-94			
CAGE NO 09922	ECN 3129	PC 830	
© BURNDY CORPORATION 1994			
APPROVAL	DRWN	NF	9-13-67
	CHKD	CAR	9-21-67
	DSGN	MP	9-21-67
	MKT	MG	10-28-94
	QC	SJ	10-28-94
DRAWING SCALE 5 : 1			
DRAWING NO			REV
SC60760			4
SHEET 1 OF 1			

LINEAR MEASURE: INCH mm INCH [mm]	
THIRD ANGLE PROJECTION	
- TOLERANCES - UNLESS OTHERWISE SPECIFIED	
NO OF DECIMAL PLACES IN INCHES	INCH [mm]
ONE PLACE	±.1 [±3]
TWO PLACES	±.02 [±0.5]
THREE PLACES	±.005 [±0.13]
ANGLES ±1°	

