

Flush-type connector - SACC-E-MS-4CON-M16/0,5 SCO PO - 1401052

Please be informed that the data shown in this PDF Document is generated from our Online Catalog. Please find the complete data in the user's documentation. Our General Terms of Use for Downloads are valid (<http://download.phoenixcontact.com>)



Sensor/actuator sealed flush-type connector, 4-pos., M12 SPEEDCON, A-encoded, front/screw mounting with M16 thread, with 0.5 m TPE litz wire, 4 x 0.34 mm²

Key commercial data

Packing unit	0
Minimum order quantity	50
GTIN	 4 046356 519977
Custom tariff number	85444290
Country of origin	GERMANY

Classifications

eclass

eCl@ss 4.0	27250313
eCl@ss 4.1	27250313
eCl@ss 5.0	27143423
eCl@ss 5.1	27143423
eCl@ss 6.0	27143423
eCl@ss 7.0	27449001

etim

ETIM 3.0	EC002061
ETIM 4.0	EC002061

unspsc

UNSPSC 6.01	31251501
UNSPSC 7.0901	31251501
UNSPSC 11	31251501
UNSPSC 12.01	31251501
UNSPSC 13.2	31251501

Flush-type connector - SACC-E-MS-4CON-M16/0,5 SCO PO - 1401052

Accessories

Accessories

Assembly

Flat nut - SACC-E-MU-M16 - 1504097



Flat nut with M16 thread

Drawings

Dimensioned drawing

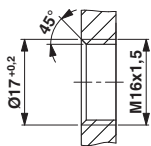

Housing cutout for M16 fastening thread, mounting panel with thread

Dimensioned drawing

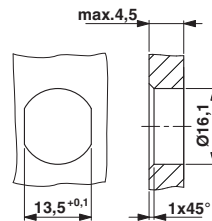

Housing cutout for M16 fastening thread, mounting panel with feed-through hole (alternatively with surface as protection against rotation)

Schematic diagram

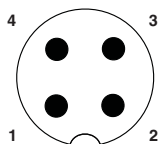

Pin assignment M12 plug, 4-pos., A-coded, view plug side

Dimensioned drawing

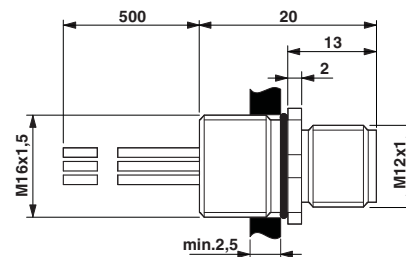

M12 flush-type connector

Flush-type connector - SACC-E-MS-4CON-M16/0,5 SCO PO - 1401052

Circuit diagram

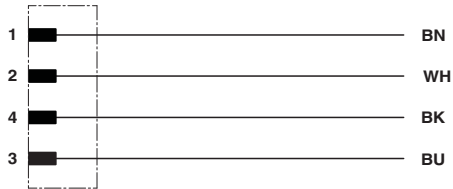

Contact assignment of the M12 plug and the M12 socket

© Phoenix Contact 2012 - all rights reserved
<http://www.phoenixcontact.com>