

Base strip - MSTB 2,5 HC/ 8-GF-5,08 BK - 1763740

Please be informed that the data shown in this PDF Document is generated from our Online Catalog. Please find the complete data in the user's documentation. Our General Terms of Use for Downloads are valid (<http://download.phoenixcontact.com>)

Header, Nominal current: 16 A, Rated voltage (III/2): 320 V, Number of positions: 8, Pitch: 5.08 mm, Color: black, Contact surface: Tin, Assembly: Soldering



The figure shows a 10-position version of the product



Key commercial data

| | |
|--------------------------------------|----------|
| Packing unit | 1 pc |
| Minimum order quantity | 50 pc |
| Weight per Piece (excluding packing) | 4.43 GRM |
| Custom tariff number | 85366990 |
| Country of origin | Germany |

Technical data

Dimensions

| | |
|----------------|----------|
| Length | 12 mm |
| Pitch | 5.08 mm |
| Dimension a | 35.56 mm |
| Pin dimensions | 1 x 1 mm |
| Pin spacing | 5.00 mm |
| Hole diameter | 1.4 mm |

General

| | |
|-----------------------------|--------------------|
| Range of articles | MSTB 2,5 HC/...-GF |
| Insulating material group | I |
| Rated surge voltage (III/3) | 4 kV |
| Rated surge voltage (III/2) | 4 kV |
| Rated surge voltage (II/2) | 4 kV |
| Rated voltage (III/3) | 250 V |

Base strip - MSTB 2,5 HC/ 8-GF-5,08 BK - 1763740

Technical data

General

| | |
|---|---------------------------|
| Rated voltage (III/2) | 320 V |
| Rated voltage (II/2) | 400 V |
| Connection in acc. with standard | EN-VDE |
| Nominal current I _N | 16 A (see derating curve) |
| Maximum load current | 16 A |
| Insulating material | PA |
| Inflammability class according to UL 94 | V0 |
| Color | black |
| Number of positions | 8 |

Classifications

eCl@ss

| | |
|------------|----------|
| eCl@ss 4.0 | 272607xx |
| eCl@ss 4.1 | 27260701 |
| eCl@ss 5.0 | 27260701 |
| eCl@ss 5.1 | 27260701 |
| eCl@ss 6.0 | 27260704 |
| eCl@ss 7.0 | 27440402 |
| eCl@ss 8.0 | 27440402 |

ETIM

| | |
|----------|----------|
| ETIM 3.0 | EC001121 |
| ETIM 4.0 | EC002637 |
| ETIM 5.0 | EC002637 |

UNSPSC

| | |
|---------------|----------|
| UNSPSC 6.01 | 30211810 |
| UNSPSC 7.0901 | 39121409 |
| UNSPSC 11 | 39121409 |
| UNSPSC 12.01 | 39121409 |
| UNSPSC 13.2 | 39121409 |

Drawings

Base strip - MSTB 2,5 HC/ 8-GF-5,08 BK - 1763740

Drilling diagram

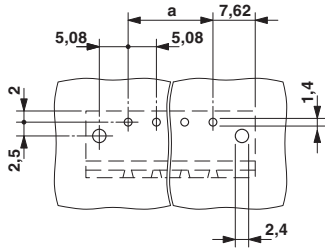

Dimensioned drawing

