

Appliance Outlet, Cord Connector (Rewireable), Straight, for Low Voltage



70° C



Description

- Connector:
Screwing cable terminal, Pin temperature 70 °C, Protection class II, Cable
- Note: Please order pvc strain relief seperately, mating strain reliefs please find under accessories.

References

Weblinks

[pdf](#), [html](#), [General Product Information](#), [Approvals](#), [RoHS](#), [CHINA-RoHS](#), [Mating Connectors](#), [e-Store](#), [SCHURTER-Stock-Check](#), [Distributor-Stock-Check](#), [Accessories](#)

Technical Data

Ratings IEC	7 A / 48 VAC; 50 Hz
Ratings UL/CSA	7 A / 48 VAC; 60 Hz
Dielectric Strength	> 3 kVAC between L-N
	> 1.5 kVAC between L/N-PE (1 min/50 Hz)
Allowable Operation Temp.	-25 °C to 70 °C
Degree of Protection	from front side IP 20 acc. to IEC 60529
Protection Class	Suitable for appliances with protection class 2 acc. to IEC 61140
Terminal	Screw clamps
Material: Housing	PA6, black / grey / white, UL 94V-0

Dimensions

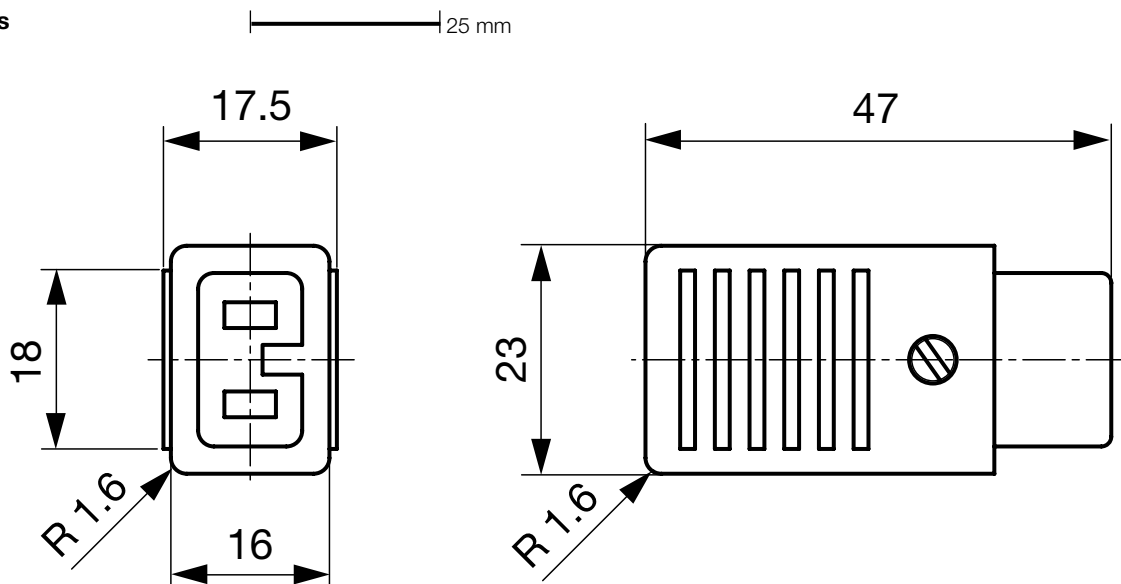

Config. Code

1251 - H - A B C 0 - D - E J

The characters are placeholders for the correspondingly keys of selections from the key tables.

1251 - H - A B C 0 - D - E J = Type

Type	Configuration key
protection class 2	B

1251 - H - A B C 0 - D - E J = Terminals

Terminal L	Configuration key
screw terminal	A

1251 - H - A B C 0 - D - E J = Terminals

Terminal N	Configuration key
screw terminal	A

Symbols similar as in table A

1251 - H - A B C 0 - D - E J = Terminals

Terminal Ground	Configuration key
without terminal	0

Symbols similar as in table A

1251 - H - A B C 0 - D - E J = Color

Color	Configuration key
jet black; RAL9005	A
silver grey; RAL7001	B
pure white; RAL9010	D

1251 - H - A B C 0 - D - E J = Style

Style	Configuration key
for cord assembly	8

1251 - H - A B C 0 - D - E J = Condition

Condition	Configuration key
assembled	1
disassembled	2

Variants

Config. Code	Description	Order Number
1251-X-AA00-A-81	1251, Plug, 70°C, version: 2, L: screw terminal, N: screw terminal, color: jet black; RAL9005, design: for cord assembly, condition: assembled	4310.0013

The listed variants should be available from stock. Other versions on request www.schurter.com/contact

Packaging unit 50 Pcs

Accessories

Description



HN 14.40
PVC Strain Relief

Mating Inlets/Plugs

Category / Description



[Special Connector Designs](#)[Overview complete](#)

Appliance inlet for low voltage, Snap-in Mounting, Front Side, Solder or Quick-connect Terminal	1201
Appliance inlet for low voltage, Snap-in Mounting, Front Side, Solder or Quick-connect Terminal	1201-A

[Special Connector Designs](#)[further types to1251](#)