

# PA20SS-P54 Data Sheet

## 20 pin SSOP socket/18 pin DIP 0.3" plug

### Supported Device/Footprints

Using this adapter, the Microchip PIC16C54 & PIC16C56 (and others) in 20 pin SSOP packages can be programmed on DIP programmers.

Mfgr	Device		Programmer	
	Device	Package	Device	Plug
Microchip	PIC16C54	SSOP	PIC16C54	18 pin DIP
	PIC16C54A			
	PIC16C56			
	PIC16C58A			
	PIC16C620			
	PIC16C621			
	PIC16C622			
	PIC16F628A			
	PIC16F648A			
	PIC16F716			
	PIC16F716			
	PIC16F716			

### Device Dimensions

This socket can accept devices of the following dimensions

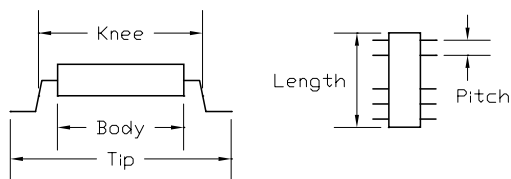

Body mm (inches)			Knee mm (inches)		
min.	typ.	max.	min.	typ.	max.
n/a	5.3 (0.209)	5.7 (0.224)	n/a	6.4 (0.250)	6.5 (0.256)
Tip mm (inches)			Body Length	Lead Pitch	
min.	typ.	max.	n/a	0.65 (0.0256)	
7.6 (0.299)	7.8 (0.307)	8.0 (0.315)			

### Adapter Dimensions

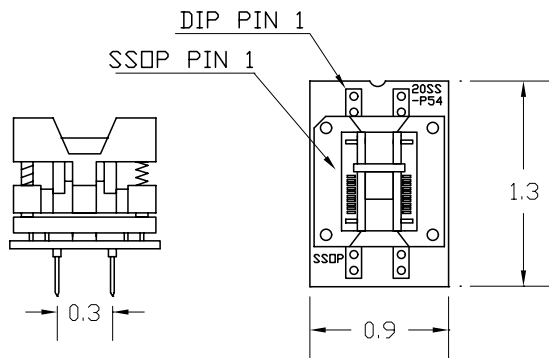

### Adapter Construction

The adapter is made up of 2 sub-assemblies. They assemble via connectors making the adapter modular. This way the sub-assemblies can be replaced when they wear out.

When disassembling the adapter take care not to bend the pins. When reassembling the adapter note the pin 1 indicators to align the parts correctly.

### Test Socket

SSOP Open top test socket:  
Enplas Part #: OTS-20(34)-0.65-01  
LSC Part #: 20(34)SG-01

### 20SS-P54

Accepts the test socket and performs the wiring in the Adapter Wiring section.

### Adapter Wiring

The following chart shows the connections from the SSOP device to the adapter's DIP plug.

DEVICE	SIGNAL	PLUG
1	RA2	1
2	RA3	2
3	RTCC	3
4	MCLR	4
5**	Vss	5
6**	Vss	5
7	RB0	6
8	RB1	7
9	RB2	8
10	RB3	9
11	RB4	10
12	RB5	11
13	RB6	12
14	RB7	13
15**	Vdd	14
16**	Vdd	14
17	OSC2/CLKOUT	15
18	OSCR	16
19	RA0	17
20	RA1	18

\*\*Pins 5-6 and 15-16 are shorted.

# LOGICAL

Logical Systems Corporation  
PO Box 6184, Syracuse, NY 13217-6184 USA  
Tel (315) 478-0722, FAX (315) 479-6753  
www.logicals.com, Email: info@logicals.com

PA20SS-P54 Data Sheet  
Doc: 20SSP54.DOC  
Rev 2//06/09  
Page 1 of 1